

DRAWING

AREA DETAIL		
• ENTRANCE LOBBY	=5.2 X 2.7	
• INCHARGE ROOM	= 14.2 SQ.M.	
• ELECTRICAL ROOM	= 2 X 2.7	
• A.C. EQUIPMENT ROOM	= 5.4 SQ.M.	
• PACKAGING ROOM 1	= 3 X 4.7	
• PACKAGING ROOM 2	= 14.2 SQ.M.	
• WIC	= 4 X 4.7	
• WIF	= 19.1 SQ.M.	
• CONTROL ROOM	= 5.7 X 9.4	
• CHANGE ROOM	= 53.86 SQ.M.	
• PASSAGE	= 66.7 SQ.M.	
• EQUIPMENT ROOM	= 7.0 X 9.45	
	= 66.6 SQ.M.	
	= 9.6 X 4.5	
	= 54.72 SQ.M.	
	= 4.9 X 2.7	
	= 13.23 SQ.M.	
	= 2.3 X 4.7	
	= 10.81 SQ.M.	
	= 18.5 X 2.7	
	= 49.95 SQ. M.	
	= 3 X 4.7	
	= 14 SQ. M	

TOTAL AREA =373.04 SQ.M.

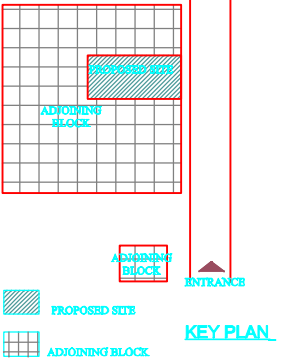

- NOTES:
1. This drawing is copyright.
  2. This drawing should not be reproduced or handed over to third party without consent of competent authority.
  3. Do not scale from this drawing.
  4. All dimensions are in millimetres unless noted otherwise.
  5. These drawings are only indicative and not to be used for construction on site.
  6. Do not make any structural changes on site.The same are not recommended.

S.NO.	REVISION ( READ DOWNWARD )	DATE
1.		
2.		
1.	FOR TENDER	18-01-10
S.NO.	ISSUED TO ( READ UPWARD )	DATE

PROJECT  
UPGRADATION OF COLD CHAIN FACILITIES IN THE GOVERNMENT MEDICAL STORE DEPOTS AT DELHI KARNAL, HYDERABAD, MUMBAI, CHENNAI KOLKATA & GUWAHATI.

FLOOR PLAN	
(HYDERABAD)	SCALE
	JAN 2010
TITLE	
DATE	

OWNER:-

ARCHITECT:-

AR DWG.NO.: GMSD/HYD/AR/01  
DEALT BY:

ARCHITECT :  
SURINDER SAWHNEY ASSOCIATES  
ARCHITECTS & DESIGN CONSULTANTS  
# 571, SECTOR-18-B, CHANDIGARH  
E-MAIL: surindersawhney@sify.com  
PH:0172-2780535,FAX : 0172-2726627.

FLOOR PLAN

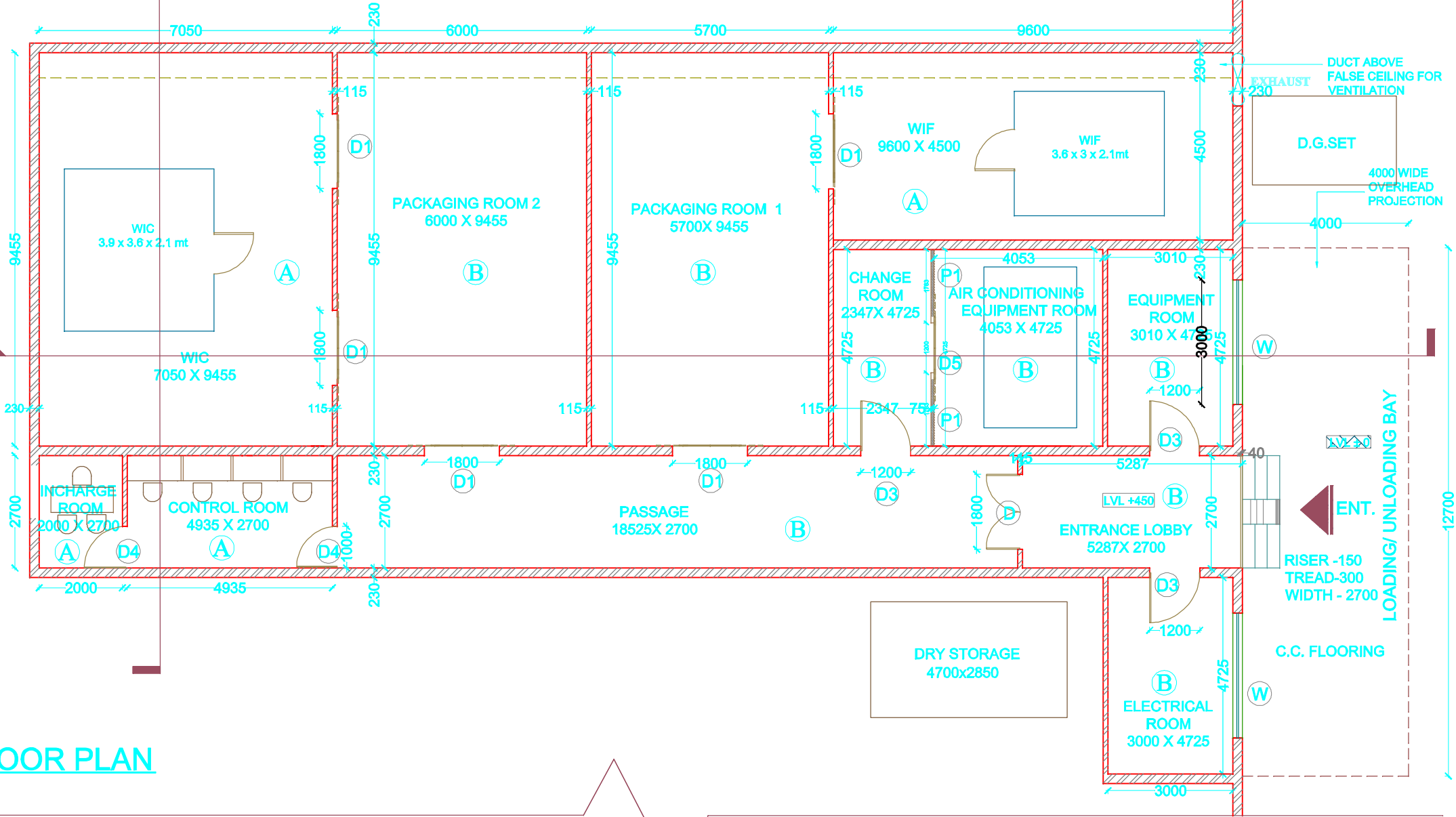

PROPOSED ACTIVITY CHART

- ENTRANCE LOBBY = 14.2 SQ.M.
- INCHARGE ROOM = 5.4 SQ.M.
- ELECTRICAL ROOM = 14.2 SQ.M.
- A.C. EQUIPMENT ROOM = 19.1 SQ.M.
- PACKAGING ROOM 1 = 53.86 SQ.M.
- PACKAGING ROOM 2 = 56.7 SQ.M.
- WIC = 66.6 SQ.M.
- WIF = 54.72 SQ.M.
- CONTROL ROOM = 13.23 SQ.M.
- CHANGE ROOM = 10.81 SQ.M.
- PASSAGE = 49.95 SQ. M.
- EQUIPMENT ROOM = 14 SQ. M

TOTAL AREA =373.04 SQ.M.

DOOR/ WINDOW SCHEDULE

S.NO	NAME OF DOOR	DOOR TYPE	WIDTH	HEIGHT	NO'S
1	D				1
1	D1	DOUBLE HINGED	1.8 MTS	2.4 MTS	5
2	D2	SLIDING	1.8 MTS	2.4 MTS	
3	D3	SLIDING	1.8 MTS	2.1 MTS	
4	D4	HINGED	1.2 MTS	2.1MTS	3
5	D5	HINGED	1.0 MTS	2.1MTS	2
6	D5	SLIDING	1.2 MTS	2.1MTS	1

FLOORING/CEILING SPECIFICATIONS

A	WIC/ WIF CONTROL ROOM INCHARGE ROOM	600 X 600 MM ANTISKID VITRIFIED TILES  METALLIC FALSE CEILING PANELS
	PACKAGING AREA ELECTRICAL ROOM DRY STORAGE CHANGE ROOM EQUIPMENT ROOM VERANDAH	KOTA STONE FLOORING  METALLIC FALSE CEILING PANELS  KOTA STONE FLOORING