

**TENDER FOR RENOVATION OF LABOUR ROOM ON
TURNKEY BASIS
(CIVIL AND ELECTRICAL WORKS)**

FOR

**HIMACHAL PRADESH - POST GRADUATE AYURVEDIC COLLEGE,
PAPROLA**

IFB NO. HLL/AFT-CMO/ HP-VII/CIV&ELE/2016-17, DT. 21.02.2017



HLL LIFECARE LIMITED

(A GOVT. OF INDIA ENTERPRISE)

AKKULAM FACTORY, SREEKARIAM P.O.

THIRUVANANTHAPURAM – 17

Phone +91 471 244 5930, Fax +91 471 244 5935

Email: hcdcmo@lifecarehll.com

Web: www.lifecarehll.com

HLL LIFECARE LIMITED
AKKULAM FACTORY, SREEKARIAM P.O. THIRUVANANTHAPURAM - 17

**TENDER FOR RENOVATION OF LABOUR ROOM AT POST GRADUATE AYURVEDIC COLLEGE, PAPROLA
ON TURNKEY BASIS
(CIVIL AND ELECTRICAL WORKS)**

BID REFERENCE : HLL/AFT-CMO/HP-VII/CIV&ELE/2016-17
Dt.21.02.2017

DATE OF COMMENCEMENT
OF SALE OF BIDDING DOCUMENT : 21.02.2017

LAST DATE FOR SALE OF BIDDING
DOCUMENT : 28.02.2017, 11..30 Hrs.

LAST DATE AND TIME FOR
RECEIPT OF BIDS : 28.02.2017, 14.00 Hrs.

TIME AND DATE OF OPENING
OF BIDS : 28.02.2017, 15.00 Hrs.

PLACE OF OPENING OF BIDS : HLL LIFECARE LIMITED
AKKULAM FACTORY,
SREEKARIAM P.O.
THIRUVANANTHAPURAM – 17
Phone +91 471 244 5930
Fax +91 471 244 5935
Email: hcdcmo@lifecarehll.com

ADDRESS FOR COMMUNICATION : **Joint General Manager (Mtls)**
HLL LIFECARE LIMITED
AKKULAM FACTORY,
SREEKARIAM P.O.
THIRUVANANTHAPURAM - 17
Phone +91 471 244 5930
Fax +91 471 244 5935
Email: hcdcmo@lifecarehll.com

ABSTRACT

SECTION No.	DESCRIPTION	PAGE No.
<u>PART A</u>		
SECTION I	INVITATION FOR BIDS (IFB)	04
SECTION II	INSTRUCTION TO BIDDERS (ITB)	05
SECTION III	GENERAL CONDITIONS OF CONTRACT (GCC)	14
SECTION IV	SPECIAL CONDITIONS OF CONTRACT (SCC)	20
SECTION V	QUALIFICATION CRITERIA	22
SECTION VI	PROFORMA ABOUT THE CONTRACTOR	23
SECTION VII	PERFORMANCE STATEMENT	24
SECTION VIII	INDEMNITY CLAUSE	25
SECTION IX	DECLARATION	26
<u>PART : B</u>		
SECTION X	ABSTRACT PRICE SCHEDULE	28
SECTION XI	PRICE SCHEDULE (I)	29

PART – A

SECTION I

INVITATION FOR BIDS (IFB)

Sealed and super scribed tenders, under Two Bid system, is invited from the eligible contractors, for execution of Renovation of Labour Room at Post Graduate Ayurvedic College, Paprola, Himachal Pradesh State on turnkey basis. The detailed work is given as in the Price Schedule to this Tender.

Sl. No.	Details of Sites in the Hospitals	EMD Amount (Rs)
1	Renovation of Labour Room at Post Graduate Ayurvedic College, Paprola, Himachal Pradesh State on turnkey basis	20,000.00

1. Interested eligible Bidders may obtain further information from the **Office of the Joint General Manager (Mtls), HLL Lifecare Ltd, Akkulam Factory, Thiruvananthapuram -17, Kerala**
2. Deleted.
3. The Tender Document can be downloaded from our Website www.lifecarehll.com.
4. Interested eligible bidders may submit their bidding documents at the Office of the **Joint General Manager (Mtls), HLL Lifecare Ltd, Akkulam Factory, Thiruvananthapuram –17** on the specified date and time.
5. All bids must be accompanied by the documents specified herein and must be delivered to **Joint General Manager (Mtls) on or before 28.02.2017, 14.00 Hrs. The Technical Bids will be opened on 28.02.2017, at 15.00 Hrs**, in the presence of the bidders or their duly authorized representatives who wish to attend the bid opening on the specified date and time at HLL's office mentioned above. In the event of the date being declared is a closed holiday for HLL, the due date for submission of bids and opening of bids will be the following working day at the appointed time.

SECTION II INSTRUCTION TO BIDDERS

A.INTRODUCTION

1. Eligible Bidders

1.1 Only experienced contractors are eligible to participate in the tender.

The tenderer shall furnish, as part of its tender, relevant details and documents establishing its eligibility to quote and its qualifications to perform the contract if its tender is accepted.

1.2 The documentary evidence needed to establish the tenderer's qualifications shall fulfill the following requirements:

a) The tenderer has the required financial, technical and service capability necessary to perform the contract and, further, it meets the qualification criteria incorporated in the Section V in these documents.

1.3 a) The bidder should have **Minimum 3 years experience in the relevant field (SECTION V)**

b) The Tenderer should have executed satisfactorily at least 3 jobs preferably of similar kind (CIVIL AND ELECTRICAL WORKS) as mentioned in SECTION V – Qualification Criteria

1.4 Bidder submit annual turnover statement for last 3 financial years, each year not less than atleast 25 lakhs, certified by Chartered Accountant.

1.5 The bidders should quote for all the schedules in the Tender, failing which, such bids shall be considered as incomplete and will be summarily rejected.

2. Cost of Bidding

2.1 Cost of bidding shall be completely on the tenderer.

B. THE BIDDING DOCUMENTS

3. Contents of Bidding Documents

3.1 The work required, bidding procedures and contract terms are prescribed in the Bidding documents. In addition to the Invitation for Bids, the Bidding documents include:

- a. Instruction to Bidders (ITB);
- b. General Conditions of Contract (GCC);
- c. Special Conditions of Contract (SCC);
- d. Qualification criteria;
- e. Proforma about the Contractor
- f. Performance statement
- g. Indemnity Clause
- h. Declaration
- i. Abstract Price Schedule
- j. Price Schedules

- 3.2 The Bidder is expected to examine all instructions, forms, terms and specifications in the Bidding Documents. Failure to furnish all information required by the Bidding Documents or submission of a bid not substantially responsive to the Bidding Documents in every respect will be at the Bidder's risk and may result in rejection of its bid.

4. Clarification of Bidding Documents

- 4.1 The Bidder, who require any clarification of the Bidding Documents may notify the Company in writing at the Company's mailing address indicated in the Invitation for Bids. The Company will respond in writing to any such request which is received not later than **3 days** prior to the deadline for submission of bids prescribed by the Company. Any such response (relevant) against the clarification of the tenderer shall be notified in our website only.

5. Amendment of Bidding Documents

- 5.1 At any time prior to the deadline for submission of bids, the Company may, for any reason, whether at its own initiative or in response to a clarification requested by a prospective bidder, modify the Bidding Documents by an amendment.

Those bidders who download the tender documents from our website should furnish the Name and address of the vendor, name of contact person, telephone and Email details immediately by Email to **hcdcmo@lifecarehll.com**. Any changes pertains to this tender shall be communicated only through our website **www.lifecarehll.com**

- 5.2 All prospective bidders who have received the Bidding Documents will be notified of the amendment in writing or by cable and will be binding on them.
- 5.3 In order to allow prospective bidders reasonable time in which to take the amendment into account in preparing their bid, the Company may, at its discretion, extend the deadline for the submission of bids

C. PREPARATION OF BIDS

6. Language of Bid

- 6.1 The Bid prepared by the bidder and all correspondence and documents relating to the bid exchanged by the Bidder and the Company, shall be written in the English language. Supporting documents and printed literature furnished by the Bidder may be written in another language provided they are accompanied by an accurate translation of the relevant passages in the English language in which case, for purposes of interpretation of the Bid, the English translation shall govern.

7. Documents Comprising the Bid

Following documents and forms are to be included in the technical bid and commercial bid respectively.

7.1 TECHNICAL BID

The technical bid shall consist of the following documents.

- a) **Tender Fee : DD for Rs. 525.00 (inclusive of tax) drawn in favour of HLL Lifecare Limited payable at Thiruvananthapuram** is to be attached towards tender fee.
- b) **EMD/Bid Security for Rs. 20,000.00 in the form of Demand Draft from schedule Bank, drawn in favor of HLL Lifecare Limited, payable at Thiruvananthapuram.** The EMD/Bid Security shall be refunded to the non-responsive bidders within 60 days from the date of opening of Bid. The Tender received without EMD will be rejected.
- c) SSI/MSME units interested in availing exemption from payment of Tender Fee & EMD should submit a valid copy of their registration certificate issued by the concerned DIC or NSIC / **Udyog Aadhaar**. But the Party has to provide Security deposit if Tender is awarded to them.
- d) Copy of Balance sheet / Bank Statement for the past two financial years.
- e) Performance statement in the Proforma VII.
- f) Documentary evidence established in accordance with ITB Clause A1 that the Bidder is eligible to bid and is qualified to perform the contract if its bid is accepted;

7.2 PRICE BID

Duly filled Bid Form i.e. Price bid Abstract and Price Schedule as per Price Bid.

- 7.3 The Work Order shall be placed to the tenderer, whose total rate comes to lowest and responsive.

8. Bid Currencies

- 8.1 Prices shall be quoted in Indian Rupees.

9. Documents establishing bidder's eligibility and qualifications

- 9.1 Pursuant to ITB Clause 1, the bidder shall furnish, as part of its bid, documents establishing the bidder's eligibility to bid and its qualifications to perform the Contract.
- 9.2 The documentary evidence of the Bidder's qualifications to perform the Contract if its bid is accepted, shall establish to the Company's satisfactions.

- (a) that the bidder has the financial and technical capability necessary to perform the Contract and meets the criteria outlined in the qualification requirements specified in Section V. All bids submitted shall include the following information:

Details of experience and past performance of the bidder on items offered and on those of similar nature and details of current contracts in hand and other commitments as per proforma given in Section VII

10. Scope of Documents:

- 10.1 For the purpose of the documentary evidence to be furnished pursuant to ITB Clause 9.2 above, the Bidder shall note that the standards for workmanship, material and references to brand names or catalogue numbers, if any, designated by the Company in its Tender schedules are intended to be descriptive only and not restrictive.

11. Period of Validity of Bids

- 11.1 Price Bid shall be valid **for One year from the date of opening of Price Bid**
- 11.2 In exceptional circumstances, the Company may solicit the bidders consent to an extension of the period of validity. The request and the responses thereto shall be made in writing.

12. Format and Signing of Bid.

- 12.1 The bidder shall prepare the bid clearly marking as appropriate
- 12.2 The bid shall be typed or written in indelible ink and shall be signed by the Bidder or a person or persons duly authorized to bind the Bidder to the Contract. The letter of authorization shall be indicated by written power-of-attorney accompanying the bid. All pages of the bid, except for printed literature, shall be initialed by the person(s) signing the bid.
- 12.3 Any interlineations, erasures or overwriting shall be valid only if they are initialed by the person or person(s) signing the bid.

D. SUBMISSION OF BIDS

13. Sealing and Marking of bids

Separate bids shall be submitted for Price Bid and Technical Bids.

- 13.1 The bidders shall seal **Technical bid** and **Price bid** separately, duly written on the envelopes as **“TECHNICAL BID – Renovation of Labour Room at Post Graduate Ayurvedic College, Paprola, Himachal Pradesh State .”** - cover “A” and **“PRICE BID- Renovation of Labour Room at Post Graduate Ayurvedic College, Paprola, Himachal Pradesh State.”** - cover “B”. The Bidders shall put both the envelopes (cover “A” & cover “B”) in an another envelope.

The outer Envelop shall superscribed with ;

**“TENDER FOR RENOVATION OF
LABOUR ROOM AT POST GRADUATE AYURVEDIC COLLEGE, PAPROLA, HIMACHAL
PRADESH**

“HLL/AFT-CMO/HP-VII/CIV&ELE/2016-17, DT. 21.02.2017”

“DO NOT OPEN BEFORE 15.00 Hrs. on 28.02.2017”

- 13.2 The inner and outer envelopes shall be addressed to the following address:

**Joint General Manager (Materials)
HLL Lifecare Limited,
Akkulam Factory, Sreekaryam P.O. ,
Thiruvananthapuram -17
Phone 0471 2445930 / 2442642
Email : hcdcmo@lifecarehll.com**

- (a) The inner envelopes shall also indicate the name and address of the bidder to enable the bid to be returned unopened in case it is declared “Technically not qualified”.
- (b) If the inner and outer envelopes are not sealed and marked as required, the Company will assume no responsibility for the bid’s misplacement or premature opening.
- (c) Bids must be received by the Company at the address specified not later than the date and time specified in the Invitation For Bid. In the event of the specified date for the submission of bids, being declared a holiday for the Company, the bids will be received up to the appointed time on the next working day.
- (d) The Company may, at its discretion, extend this deadline for the submission of bids by amending the bidding documents in which case all rights and obligations of the Company and bidders previously subject to the deadline will thereafter be subject to the deadline as extended.

14. LATE BIDS

14.1 Any bid received by the Company after the deadline for submission of bids prescribed by the Company, will be rejected and returned unopened to the bidder.

15. MODIFICATION AND WITHDRAWAL OF BIDS

15.1 The bidder may modify or withdraw its bid after the bid submission, provided that written notice of the modification or withdrawal is received by the Company prior to the deadline prescribed for submission of bids.

15.2 The bidder's modification or withdrawal notice shall be prepared, sealed, marked and dispatched in accordance with the provisions of ITB Clause 15. A withdrawal notice may also be sent by cable, but followed by a signed confirmation copy, post-marked not later than the deadline for submission of bids.

15.3 No bid may be modified subsequent to the deadline for submission of bids.

15.4 No bid may be withdrawn in the interval between the deadline for submission of bids and the expiration of the period of bid validity specified by the bidder in the Bid Document.

E. BID OPENING AND EVALUATION

16. Opening of Bids by Company

16.1 The Company will open all technical bids (Cover A), in the presence of bidder's representatives who choose to attend, at 15.00 Hrs on 01.02.2017 at the following Office

**JOINT GENERAL MANAGER (MATERIALS)
HLL Lifecare Limited,
Akkulam Factory, Sreekaryam P.O. ,
Thiruvananthapuram -17
Phone 0471 2445930 / 2442642
Email : hcddcmo@lifecarehll.com**

16.2 In the event of the specified date of bid opening being declared a holiday for the Company, the bids shall be opened at the appointed time and location on the next working day.

16.3 The bidder's names, modifications, bid withdrawals and the presence or absence of the requisite documents and such other details as the Company, at its discretion, may consider appropriate will be announced at the opening. No bid shall be rejected at bid opening, except for late bids, which shall be returned unopened to the bidder.

16.4 Deleted

- 16.5 The “Price Bid” (Cover B) will be opened after evaluation of “Technical bids” (Cover A) and the date and time will be intimated to bidders whose bids are responsive to and Qualified in the Technical Bid.
- 16.5 The Company will scrutinize the technical bid for compliance to the conditions and documentation requirement as per the bid document. The bidders will be short-listed on the basis of responsiveness of technical bid. The price bid of the bidders who are disqualified at the technical scrutiny and on-site evaluation, as applicable, will be returned un-opened. The short listed bidders will be informed about the time, date and venue of the price bid opening. The successful bidder shall be identified on the basis of lowest evaluated substantially responsive bid.

17. CLARIFICATION OF BIDS

- 17.1 During evaluation of bids, the Company may, at its discretion, ask the bidder for a clarification of its bid. The request for clarification and the response shall be in writing and no change in prices or substance of the bid shall be sought, offered or permitted.

18 PRELIMINARY EXAMINATION

- 18.1 The Company will examine the bids to determine whether they are complete, whether any computational errors have been made, whether the documents have been properly signed, and whether the bids are generally in order.
- 18.2 Arithmetical errors will be rectified on the following basis. If there is a discrepancy between the unit price and the total price that is obtained by multiplying the unit price and quantity, the unit price shall prevail and the total price shall be corrected. If there is a discrepancy between words and figures, the amount in words will prevail. If the bidder does not accept the correction of the errors, its bid will be rejected.
- 18.3 The Company may waive any minor informality or non-conformity or irregularity in a bid, which does not constitute a material deviation, provided such a waiver does not prejudice or affect the relative ranking of any bidder.
- 18.4 Prior to the detailed evaluation, pursuant to Clause ITB 21, the Company will determine the substantial responsiveness of each bid to the bidding documents. For purposes of these clauses a substantially responsive bid is one which conforms to all the terms and conditions of the bidding documents without material deviations. Deviations from or objections or reservations to critical provisions such as those concerning Warranty, Force Majeure, Applicable law and Taxes and Duties will be deemed to be material deviation. The Company’s determination of a bid’s responsiveness is to be based on the contents of the bid itself without recourse to extrinsic evidence.

- 18.5 If a bid is not substantially responsive, it will be rejected by the Company and may not subsequently be made responsive by the bidder by correction of the non-conformity.

19. EVALUATION AND COMPARISON OF BIDS

- 19.1 The Company will evaluate and compare bids previously determined to be substantially responsive, pursuant to ITB Clause 20.

20. CONTACTING THE COMPANY

- 20.1 No bidder shall contact the Company on any matter relating to its bid, from the time of the bid opening to the time the contract is awarded. If the bidder wishes to bring additional information to the notice of the Company it should do so in writing.
- 20.2 Any effort by a bidder to influence the Company in its decisions on bid evaluation, bid comparison, or selection may result in the rejection of the bidders bid.

F. AWARD OF CONTRACT

21. POST QUALIFICATION

- 21.1 In the absence of pre-qualification, the Company will determine to its satisfaction whether the bidder who has having submitted the lowest evaluated responsive bid meets the criteria specified in ITB Clause 1 and is qualified to perform the contract satisfactorily
- 21.2 The determination will take into account the bidders financial, technical capabilities. It will be based upon an examination of the documentary evidence of the bidder's qualifications submitted by the bidder, pursuant to ITB Clause 1 as well as such other information as the Company deems necessary and appropriate.
- 21.3 An affirmative determination will be a prerequisite for award of the contract to the bidder. A negative determination will result in rejection of the bidders bid, in which event the Company will proceed to the next lowest evaluated bid to make a similar determination of that bidder's capabilities to perform satisfactorily.

22. AWARD CRITERIA

- 22.1 Subject to ITB Clause 23, the Company will award the contract to the successful bidder whose bid has been determined to be substantially responsive and as the lowest evaluated bid, provided further that the bidder is determined to be qualified to perform the contract satisfactorily.

23. COMPANY’S RIGHT TO VARY QUANTITIES AT TIME OF AWARD

23.1 The Company reserves the right at the time of award of contract to increase or decrease the quantity of materials and services originally specified in the bid document without any change in unit price or other terms and conditions within the bid validity period.

24. COMPANY’S RIGHT TO ACCEPT ANY BID AND TO REJECT ANY OR ALL BIDS

24.1 The Company reserves the right to accept or reject any bid, and to annul the bidding process and reject all bids at any time prior to award of Contract, without thereby incurring any liability to the affected bidder or bidders.

25. NOTIFICATION OF AWARD

25.1 Prior to the expiration of the period of bid validity, the Company will notify the successful bidder in writing by registered letter or by mail, to be confirmed, that its bid has been accepted.

25.2 The notification of award will constitute the formation of the contract

SECTION III GENERAL CONDITIONS OF CONTRACT

1. DEFINITIONS

- 1.1 In this contract the following terms shall be interpreted as indicated:
- (a) “The Contract” means the agreement entered into between the Company and the Contractor as recorded in the Contract Form signed by the parties, including all the attachments and appendices thereto and all documents incorporated by reference therein;
 - (b) “The Contract Price” means the price payable to the Contractor under the Contract for the full and proper performance of its contractual obligations;
 - (c) “The Materials” means all the products and/or other materials which the Contractor is required to be used in the work under the Contract;
 - (d) “Services” means services ancillary to the works, other incidental services, such as installation, commissioning, provision of technical assistance, and other obligations of the Contractor covered under the contract.
 - (e) “GCC” means the General Conditions of Contract contained in this section.
 - (f) “SCC” means the Special Conditions of Contract.
 - (g) “The Company” means the Organization contracting the work, as named in SCC;
 - (h) “The Contractor” means the individual or firm undertaking the work / Service under this Contract;
 - (i) “Day” means calendar day.
 - (j) “Handing over period” means the period applicable upto completion of work and testing by the contractor at the required location mentioned in service purchase order and accepted by the Company.
 - (k) “Earnest Money Deposit” (EMD) means Bid Security / monetary or financial guarantee to be furnished by a tenderer along with its tender”.

2. APPLICATION

- 2.1 These General Conditions shall apply to the extent that they are not superseded by provisions in other parts of the Contract.

3. STANDARDS

- 3.1 The Work executed under this Contract shall conform to the standard requirements mentioned in the schedule.

4. USE OF CONTRACT DOCUMENTS AND INFORMATION

- 4.1 The Contractor shall not, without the Company's prior written consent, disclose the Contract, or any provision thereof, or any specification, plan, drawing, pattern, sample or information furnished by or on behalf of the Company in connection therewith, to any person other than a person employed by the Contractor in performance of the Contract. Disclosure to any such employed person shall be made in confidence and shall extend only so far as may be necessary for purposes of such performance.
- 4.2 The Contractor shall not, without the Company's prior written consent, make use of any document or information enumerated in GCC Clause 4.1 except for purposes of performing the Contract.
- 4.3 Any document, other than the Contract itself, enumerated in GCC clause 4.1 shall remain the property of the Company and shall be returned (in all copies) to the Company on completion of the contractor's performance under the Contract if so required by the Company.

5. PATENT RIGHTS

- 5.1 Deleted

6. INSPECTION AND TESTS

- 6.1 The Company or its representative shall have the right to inspect and/or to test the materials to confirm their conformity to the Contract at no extra cost of the Company. The Special conditions of Contract and/or the Technical Specifications shall specify what inspections and tests the Company requires and where they are to be conducted. The Company shall notify the Contractor in writing of the identity of any representatives retained for these purposes.
- 6.2 The inspections and test may be conducted on the premises, at point of completion and/or at the time of handing over the execution. The Contractor or its subcontractor(s), all reasonable facilities and assistance shall be extended to the inspectors at no charge to the Company.
- 6.3 Should any inspected or tested materials/work fail to meet with the schedule requirement, the Company may reject them and the Contractor shall either replace the rejected materials or make all alternations necessary to meet schedule requirements free of cost to the Company.

6.4 The Company's right to inspect, test and, where necessary, reject the materials/work at site shall in no way be limited or waived by reason of the Materials having previously been inspected, tested and passed by the Company or its representative.

7. PACKING

7.1 Deleted

8 DELIVERY AND DOCUMENTS

8.1 Deleted

9. INCIDENTAL SERVICES

9.1 The contractor may be required to provide any or all of the services with respect to this tender, including additional services, if any, specified in SCC:

10. WARRANTY

10.1 The Contractor warrants that the Materials used under this Contract are new, unused, of the most recent or current models and incorporate all recent improvements in design and materials unless provided otherwise in the Contract. The contractor further warrants that the Materials supplied under this Contract shall have no defect arising from design, materials or workmanship (except when the design and/or material is required by the Company's specifications) or from any act or omission of the Contractor, that may develop under normal use of the supplied Materials in conditions obtaining in the state/country of final destination.

10.2 This warranty shall remain **valid for one year** after work completion handing over and accepted as indicated in the Contract.

10.3 The Company shall promptly notify the contractor in writing of any claims arising under this warranty.

10.4 Upon receipt of such notice, the Contractor shall, within the period specified in SCC and with all reasonable speed, repair or replace the defective Materials or parts thereof, without cost to the Company

10.5 If the Contractor, having been notified, fails to remedy the defect(s) within the period specified in SCC within a reasonable period, the Company may proceed to take such remedial action as may be necessary, at the Contractor's risk and expense and without prejudice to any other rights which the Company may have against the Contractor under the contract.

11. PAYMENT

11.1 The method and conditions of payment to be made to the Contractor under the Contract shall be specified in the Special Conditions of Contract.

11.2 Payment shall be made in Indian Rupees

12. PRICES

12.1 Prices charged by the Contractor for Work/Services performed under the Contract shall not vary from the prices quoted/agreed by the Contractor in its bid, with the exception of any prices adjustments authorized in the special Conditions of Contract or in the Company's request for bid validity extensions, as the case may be.

13. CONTRACT AMENDMENTS

13.1 Subject to GCC Clause 17, no variation in or modification of the terms of the Contract shall be made except by written amendment signed by the parties.

14. ASSIGNMENT

14.1 The Contractor shall not assign, in whole or in part, its obligations to perform under the contract, except with the Company's prior written consent.

15. SUBCONTRACTS

15.1 The supplier shall notify the Company in writing of all subcontracts awarded under the contract if not already specified in his bid. Such notification, in his original bid or later, shall not relieve the Supplier from any liability or obligation under the contract.

16. LIQUIDATED DAMAGES

16.1 If the Contractor fails to perform the contract/services within the period(s) specified in the Contract, the Company shall, without prejudice to its other remedies under the Contract, deduct from the Contract Price, as liquidated damages, a sum equivalent to the percentage specified in SCC of the delivered price of the delayed unperformed contract/Services for each week or part thereof of delay until actual handing over or performance, up to a maximum deduction of the percentage specified in the SCC if any. Once the maximum is reached, the Company may consider termination of the Contract.

17. TERMINATION BY DEFAULT

17.1 The Company may, without prejudice to any other remedy for breach of contract, by written notice of default sent to the contractor, terminate the Contract in whole or part;

(a) if the Contractor fails to complete any or all of the work within the time period(s) specified in the Contract, or within any extension thereof granted by the Company, or

(b) if the Contractor fails to perform any other obligation(s) under the contract.

17.2 In the event the Company terminates the Contract in whole or in part, the Company may execute, upon such terms and in such manner as it deems appropriate, Work or Services similar to those unperformed, and the Contractor shall be liable to the Company for any excess costs for such similar Works. However, the Contractor shall continue the performance of the Contract to the extent not terminated.

18. FORCE MAJEURE

18.1 For purposes of this Clause “Force Majeure” means an event beyond the control of the Contractor and not involving the Contractor’s fault or negligence and not foreseeable. Such events may include, but are not limited to, acts of the Company either in its sovereign or contractual capacity, wars or revolutions, fires, floods, epidemics, quarantine restrictions and freight embargoes.

18.2 If a Force Majeure situation arises, the Contractor shall promptly notify the Company in writing of such conditions and the cause thereof. Unless otherwise directed by the Company in writing, the Contractor shall continue to perform its obligations under the Contract as far as is reasonably practical, and shall seek all reasonable alternative means for performance not prevented by the force majeure event.

19. TERMINATION FOR INSOLVENCY

19.1 The Company may at any time terminate the Contract by giving written notice to the Contractor, if the Contractor becomes bankrupt or otherwise insolvent. In this event, termination will be without compensation to the Contractor, provided that such termination will not prejudice or affect any right of action or remedy, which has accrued or will accrue thereafter to the Company.

20. RESOLUTION OF DISPUTES/ ARBITRATION

20.1 The Company and the contractor shall make every effort to resolve amicably by direct informal negotiation any disagreement or dispute arising between them under or in connection with the Contract.

20.2 If, after thirty (30) days from the commencement of such informal negotiations, the Company and the Contractor have been unable to resolve amicably a Contract dispute, either party may require that the dispute be referred for resolution to the formal mechanisms specified in the General Conditions of Contract (Arbitration Clause 20.3). These mechanisms may include, but or not limited to, conciliation

mediated by a third Party, adjudication in an agreed national forum, and national arbitration.

20.3 If, HLL and the Contractor have been unable to resolve amicably a Contract dispute, such dispute or disagreement shall be settled in accordance with the Arbitration and Conciliation Act 1996 the Arbitral Tribunal shall consist of 3 Arbitrator , one each to be nominated by the Company and the contractor. The third Arbitrator shall be chosen by the two Arbitrators so appointed by the parties and shall act as Presiding Arbitrator. In case of failure of the two Arbitrator appointed by the parties to reach upon a consensus within a period of 30 days from the appointment of the Arbitrator appointed subsequently, the Presiding Arbitrator shall be appointed by the President of Institute of Engineers (India).

20.4 The jurisdiction of any disputes, suits and proceeding arising out of the tender shall be only in the court of Thiruvananthapuram.

21. GOVERNING LANGUAGE

21.1 The contract shall be written in English language. English language version of the Contract shall govern its interpretation. All correspondence and documents pertaining to the Contract which are exchanged by the parties shall be written in the same language.

22. APPLICABLE LAW

22.1 The Contract shall be interpreted in accordance with the laws of the Union of India.

23. NOTICES

23.1 Any notice given by one party to the other pursuant to this Contract shall be sent to other party in writing or by cable and confirmed in writing to the other Party's address specified in Special Conditions of Contract.

23.2 A notice shall be effective when delivered or on the notice's effective date, whichever is later.

24. TAXES AND DUTIES

24.1 Contractors shall be entirely responsible for all taxes, licenses, statutory levies etc., incurred until handing over of the contracted site / service to the Company.

SECTION IV

SPECIAL CONDITIONS OF CONTRACT

The following Special Conditions of Contract shall supplement the General Conditions of Contract. Whenever there is a conflict, the provisions herein shall prevail over those in the General Conditions of contract. The Corresponding clause number of the General Conditions is indicated in parentheses.

1. The work shall be completed **within 20 Days** from the date of receipt of firm Work Order / L.O.I.
2. The contractor may inspect the site at Himachal Pradesh before quoting the work
3. During the execution of the work the contractor or authorized representative should be present at site.
4. Statutory deduction like Income tax, Work Tax, Service Tax, ESI, PF etc will be deducted from the Contractor's bill as per the statutory rules.
5. Security deposit: 5% of executed value shall be deducted from the first bill and shall be released after defect liability period of ONE year.
6. Payment shall be released in two parts - 50% of the total value of work may be released upon the completion of 60% of the work and the final payment (balance 50%) shall be made after successful completion of the total work. The second and final payment shall be released only after clearing all the debris/balance materials from the site. The bills are to be certified by the following official from HLL.
 - a) Electrical Engineer, CMO, Chennai
 - b) Project Engineer (Civil), CMO, Chennai.

Countersigned by any one of the following Official from HLL

- a) Business Manager (Projects & Services), CMO, Chennai
 - b) Deputy General Manager (MKTG), CMO, Chennai
7. All the materials and tools required for the work shall be procured by the contractor and brought to the site to complete the work in the time frame. Entry of men/ materials should be done through the security gate only and the details of the same shall be recorded in the register kept at the security office and the copy of details shall be submitted to the Projects in-charge. All the material brought to the work shall be as per the schedule and samples of materials shall be handed to the project in-charge.

8. The contractor has to arrange all the necessary insurance coverage for the materials/ machines / work men deployed by him.
9. Measurement is to be recorded in each stage of the work and the payment will be made on actual measurement of the work as per the order.
10. If the Contractor fails to execute any or all of the work or perform the Services within the time period(s) specified in the Tender/Purchase Order / Work order, the HLL shall, without prejudice to its other remedies under the Contract, deduct from the Contract Price, as penalty, a sum equivalent to the percentage specified in the various terms and conditions of the contract.
11. A delay by the Contractor in the performance of its contract obligations shall render the Contractor liable to the imposition of penalty pursuant to this tender/Work Order/contract, unless an extension of time is agreed upon pursuant to agreement/ Work Order without the application of liquidated damages.
12. Penalty shall be imposed as per the company rules for any delay committed by the contractor in completing the work as per the order. (Ref. Clause.16 - LIQUIDATED DAMAGES)
13. HLL reserves the right to accept or reject the tender either partially or fully without assigning any reason what so ever.

14. CONTRACT AMENDMENTS

No variation in or modification of the terms of the Contract shall be made except by written amendment signed by the parties.

15. ASSIGNMENT

The Contractor shall not assign, in whole or in part, its obligations to perform under the contract, except with the HLL's prior written consent.

16. LIQUIDATED DAMAGES

If the Contractor fails to perform the Services within the period(s) specified in the Contract, the HLL shall, without prejudice to its other remedies under the Contract, deduct from the Contract Price, as liquidated damages, a sum equivalent to 0.5 percentage of the value of the delayed Work or unperformed Services for each week or part thereof of delay until actual completion of performance, up to a maximum deduction of 10 percentage. Once the maximum is reached, the HLL may consider termination of the Contract.

SECTION V QUALIFICATION CRITERIA

(Referred to in Clause 1 of ITB Eligible Bidders)

A) For Civil

- 1) The bidder should have **Minimum 3 years experience in the relevant field.**
- 2) The Tenderer should have executed satisfactorily at least 2 jobs preferably of similar kind in the last 3 years, each contract valued atleast Rs. 15 Lakhs.

B) For Electrical

- 1) The bidder should have **Minimum 3 years experience in the relevant field.**
- 2) The Tenderer should have executed satisfactorily at least 2 jobs preferably of similar kind in the last 3 years, each contract valued atleast Rs. 5 Lakhs.

The above mentioned are the minimum qualification criteria and proof of such document shall be submitted long with the bid, failing which bid will be treated as non-responsive.

SECTION VI

PROFORMA ABOUT THE CONTRACTOR

HLL/AFT-CMO/HP-VII/CIV&ELE/2016-17, DT. 21.02.2017

(Please attach detailed proforma incorporating the information given below)

Tender No.....

DATE OF OPENING.....

NAME OF THE TENDERER:.....

1. Name & Full address of the Contractor:

(a) PAN No

(b) Service Tax Regn. No:

(C) TIN No *****

(d) CST No *****

(specify whether registered with Kerala State. Attach relevant copies as proof of evidence)

(a) Any other details

(b) Specify whether SSI / MSME unit

2. (a) Telephone No.

Office/Personal

(b) Fax No.

Office/Personal

(c) e-mail address

3. Details of Staff:

a) technical :

b) skilled :

c) unskilled :

SEAL OF THE TENDERER

SIGNATURE

NAME AND ADDRESS OF TENDERER

SECTION VII

PROFORMA FOR PERFORMANCE STATEMENT

Proforma for Performance Statement (for a period of last 3 years)

HLL/AFT-CMO/HP-VII/CIV&ELE/2016-17, DT. 21.02.2017

Name of the Tenderer:.....

Name & Address of the Tenderer / Service Provider:.....

.....

Order placed by (Full Address of Company / Consignee)	Order No. and Date	Description and quantity of ordered work and service	Value of order	Date of Completion of Contract		Remarks indicating reasons for delay, if any	Have the works been satisfactorily maintained? (Attach a documentary proof)
				As per Contract	Actual		

We hereby certify that if at any time, information furnished by us is proved to be false or incorrect, we are liable for any action as deemed fit by the Company in addition to forfeiture of earnest money.

Signature and Seal of the Bidder

.....

SECTION VIII

HLL LIFECARE LIMITED

Akkulam Factory

THIRUVANANTHAPURAM-695017

HLL/AFT-CMO/HP-VII/CIV&ELE/2016-17, DT. 21.02.2017

INDEMINITY CLAUSE

If the contractor fails to execute the order within the time prescribed for the handing over of works ordered or violates or infringes the existing rates as agreed to as mentioned in the work order, the contractor shall and will indemnify the company against all loses or damages whatsoever to be incurred or sustained including the legal cost or expenses incurred by the company by reason of non-handing over of works at agreed quantity and rate with in the time specified in the work order. The company will initiate legal action if the contractor fails to execute the work order as per the schedule in the work order for the actual loss suffered. No quantity tolerance will be permitted in this regard unless otherwise prior approval is taken by the company before executing any excess quantity and shall be at the risk of the contractor. Responsiveness of the Bid shall be at the discretion of HLL.

The contractor shall have no right to change the quantity stipulated in the work order.

Bid pronounced Non Responsive by HLL shall be summarily rejected.

The decision of HLL will be final and no correspondence of this shall be entertained.

We have read and understood the above conditions and agree to abide by the same.

PLACE:

DATE:

**NAME AND SIGNATURE OF THE TENDERER
(WITH OFFICE SEAL)**

SECTION IX

HLL LIFECARE LIMITED

Akkulam Factory

THIRUVANANTHAPURAM-695017

HLL/AFT-CMO/HP-VII/CIV&ELE/2016-17, DT. 21.02.2017

DECLARATION

I / WE, The Bidder undertake, we shall execute, within the purview of the contract, all the works and activities includes; transportation, loading, unloading and other technical work for the installation of the equipment at the designated site as per the schedule/contract /work order, at **Himachal Pradesh.**

We confirm having read and understood all the schedule requirements, instructions, forms, terms and conditions and other requirements of the above tender (both expressed and implied) in full and that we agree to abide by all without any deviation.

SEAL OF THE TENDERER

SIGNATURE
NAME AND ADDRESS OF TENDERER

PART : B

SECTION VIII ABSTRACT PRICE SCHEDULE

SECTION IX PRICE SCHEDULE

SECTION X

HLL LIFECARE LIMITED
AKKULAM FACTORY, THIRUVANANTHAPURAM-695017

RENOVATION OF LABOUR ROOM AT POST GRADUATE AYURVEDIC COLLEGE,
PAPROLA

(CIVIL AND ELECTRICAL WORKS)

ABSTRACT PRICE BID

Site. No.	Details of Sites in the Hospitals	Amount Quoted (Rs)
1	Civil Work	
2	Electrical Work	
Total Rs:		

Total words in Rupees: _____

Bidder has to quote as per the Make/Brand specified in the BOQ, proposed to use for the project, and has to marks the Make/Brand in the quote / price schedule.

SEAL OF THE TENDERER

Date:

SIGNATURE
NAME AND ADDRESS OF TENDERER

SECTION XI

HLL LIFECARE LIMITED
AKKULAM FACTORY, THIRUVANANTHAPURAM-695017
Ph: 0471 244 5930 /244 2642
hcdcmo@lifecarehll.com

**RENOVATION OF LABOUR ROOM AT POST GRADUATE AYURVEDIC COLLEGE,
 PAPROLA
 (CIVIL WORKS)
 PRICE SCHEDULE (a)**

S. No	Description of work	Qty	Unit	Unit Rate in Rs.	Total Rate in Rs.
EARTH WORK					
1	"Excavate foundation in all kinds of soil including soft rock except hard rock requiring blasting part return and fill in foundation and basement in layers not exceeding 15cm in depth including watering , breaking clods and consolidating, disposing and spreading surplus earth within the site upto 1.5m depth.(No extra shall be payable for working space) Tenderer to ensure proper dewatering and shoring methods to ensure all time dry condition. Any damages of sides of foundation or collapsing of soil from sides due to excessive water seepage or surface runoff or any other cause have to be replaced with quarry dust or Malaimann at no extra cost."	1	CUM		
TILE WORK					

S. No	Description of work	Qty	Unit	Unit Rate in Rs.	Total Rate in Rs.
2	<p>Providing and laying 600mm x 600mm from Kajaria/ Restile/Johnson glazed tiles of plain series(Satin finish) in dado set in CM 1:3 with joints so as to form a true & even surface and joints finished neatly with white cement mixed with matching pigments all complete as directed. (Rate should include base plastering with CM 1:5 of required thickness.)</p> <p>The rate shall include cost of providing 6mmx6mm groove in the plastering at top of the tile all complete as directed.(Basic cost of tile - Rs.85/sft).Any difference in basic price and OHP at the time of approval shall be adjusted for the laid area.No extra shall be payable for forming any pattern like border, etc.</p>	162.00	M.SQ		
3	<p>Providing & laying first class full body vitrified ceramic tile of make Kajaria/ Restile/Johnson or equivalent of size 600mmx600mmx 9.5mm or approved size of approved colour (matt finish) in flooring using spacer of required size (2mm-4mm) from endura or equivalent over a bed of cement mortar 1:4 of required thickness to match finished floor level mentioned and to match the neighbouring floor finish and jointed with epoxy grout of approved shade from Bal Endura or equivalent brand all complete as directed.(Basic cost of tile - Rs.85/sft).Any difference in basic price and OHP at the time of approval shall be adjusted for the laid area.No extra shall be payable for forming any pattern in the flooring like border, cut tiles,etc.</p>	94.00	M.SQ		

S. No	Description of work	Qty	Unit	Unit Rate in Rs.	Total Rate in Rs.
4	Providing and fixing 40mm thick Granite slab gang saw cut mirror polished premoulded and prepolished) machine cut for kitchen platforms, vanity counters, window sills, facias and similar locations of required size of approved shade, colour and texture laid over 20mm thick base cement mortar 1:4 (1 cemnet :4 course sand) with joints treated with white cement, mixed with matching pigment, epoxy touch ups, including rubbing, curing, moulding and polishing to edges to give high gloss finish etc complete at all levels. Area of slab over 0.5 sqm	2.00	M.SQ		
FALSE CEILING					
5	Providing & Fixing of False ceiling shall be provided with Armstrong Lay in (Hot dipped galvanized steel) metal ceiling system 600 X 600 X 5 mm with standard perforation of 2.5 mm dia. (16% open space) and fleece with NRC of 70 & CAC 36 to be laid on Armstrong Grid system. Armstrong Orcal Lay in metal ceiling system consisting of 600 X 600 mm Lay in tiles of pre coated galvanized steel in 0.5 mm thickness in white colour with standard perforation of 2.5 mm dia. and open area of 16 %. The back of tiles should have black acoustical fleece with NRC of .70 & CAC 36 to be laid on Armstrong Grid system with 15 mm wide T section flanges Colour white having rotary stitching on the main Runner, 1200 mm & 600 mm cross Tees, fixed to the structural soffit by Butterfly clip hangers, suspension wires & anchor fasteners as per manufacturers specification. Suspension wires to be provided at every 600 mm c/c with two numbers ties on each anchor fastener, Perimeter trim of Trulok wall angle in white colour secured to wall at 450 mm maximum centers.	94.00	M.SQ		
PLASTERING					
8	Prepare surfaces and plaster with CM 1:3(1 cement, 3 sand) ,12mm minimum thick (sponge finish) to ceiling sides and soffit of beams and columns and other interior and exterior RCC surfaces not contiguous to masonry.	6.00	M.SQ		
PAINTING					

S. No	Description of work	Qty	Unit	Unit Rate in Rs.	Total Rate in Rs.
11	Prepare surfaces and paint two coats of plastic emulsion paint of approved colour over two coats of Alltek S/R putty and primer all complete as per manufacturers specifications to all interior faces of walls in all floors.	136.00	M.SQ		
12	Prepare surfaces and paint three coats of 'Apolite Apex' paint of approved colour and manufacturer over approved primer to exterior faces of walls sunshades, facias, fins, drops etc all as per detailed manufacturer's specification at all floors.	QRO	M.SQ		
13	Prepare surfaces and paint with two coats of synthetic enamel paint of approved colour and manufacture over a coat of approved anticorrosive primer to iron work at all heights.	QRO	M.SQ		
	Prepare surfaces and paint two coats of Royal emulsion paint of approved colour over two coats of Alltek S/R putty and primer all complete as per manufacturers specifications to all interior faces of walls in all floors.	12.00	M.SQ		
CURTAIN WORK					
	1. Two range of curtain cloth – Type 1 - II.				
	2. Both for doors, windows and partions.				
	3. Assorted colours plain & prints				
	4. Stitched as per site/ size requirement				
	5. Minor modifications in stitching as per site/ size requirement				
	6. Preferred colour (Brown, Cream, Beige)				
	7. Curtain price (including cloth & curtain rod) to be quoted in Squire metre				
	8. Stitching for each curtain to be absorb in the price of the cloth generally 2 meters.				
	9. Fast colours, water wash				
	10. Fabric density Non Transparent Composition				

S. No	Description of work	Qty	Unit	Unit Rate in Rs.	Total Rate in Rs.
	11.Fabric of curtain shall be soft texture, great shading, drape effect and nice doobby.				
	12.The bracket shall be side mounted and front mounted as required				
	13.First rod mount is 3.5 inches from the wall.				
	14.Where curtain used as a partition/ long length, sufficient support from ceiling should be provided to avoid sagging.				
	15.Rate quoted for fully stitched Curtain with top nepha with punch holes after lining bucramreinforced with SS / PVC islets and lower nepha 200mm double turned.				
	Type -I (Surgical Curtain)				
	Curtain fabric weight shall be up to 275-300 ($\pm 5\%$) gsm Composition of fabric shall be polyester yarn I.E. 300 denier fast colour sink age shall be ($\pm 5\%$) Weft and warp shall be polyester / cotton polyester mix	15	M.SQ		
	Type - II (Window & Door Curtain)				
	Curtain fabric weight shall be up to 250-275 ($\pm 5\%$) gsm Composition of fabric shall be polyester yarn I.E. 300 denier fast colour sink age shall be ($\pm 5\%$) Weft and warp shall be polyester / cotton polyester mix	44	M.SQ		
MASONRY WORK					
1	Half brickwork with locally available best quality table moulded bricks of not less than 50kg/sq.cm crushing strength in CM 1:3 (1 cement 3 sand) and reinforced with two numbers of 6mm dia. M.S rods at every fourth course embedded in cement mortar 1:4 for partitions.				
1.1	In Ground Floor	1.00	M.SQ		

S. No	Description of work	Qty	Unit	Unit Rate in Rs.	Total Rate in Rs.
22	Cement concrete 1:4:8 (1 cement ,4 sand , 8 hard blue granite stone metal 40mm and down gauge in layers not exceeding 15 cms in depth well consolidated in foundation and levelling course under floors including necessary shuttering, in steps etc all complete as directed.	1	CUM		
DISMANTLING AND PRE & POST CONSTRUCTION SITE CLEANING					
	Cleaning the site and removing debris with carriage of material by manual labour including loading ,unloading and stacking to municipal dumping ground beyond 50 m initial lead, for all leads including all lifts involved.	1	LS		
	Dismantling of any type of tiles/flooring work including striking of serviceable material and is of unserviceable materials with all leads and lift	264	SQM		
	Dismantling plastered Half brickwalls in cement mortar including cleaning, stacking the useful materials as directed by engineer-in-charge and dumping the dismantled debris as indicated at site, levelling, consolidating, all complete as directed and disposing the debris away from site all complete as directed.	4.00	M.SQ		
14	Dismantling plastered brickwalls in cement mortar including cleaning, stacking the useful materials as directed by engineer-in-charge and dumping the dismantled debris as indicated at site, levelling, consolidating, all complete as directed and disposing the debris away from site all complete as directed.	1.00	M.CUBE		
21	Dismantling CP pipes GSW pipes and AC rain water pipes with fitting and clamps including stacking the materials with all lead and lift	6	RM		

S. No	Description of work	Qty	Unit	Unit Rate in Rs.	Total Rate in Rs.
15	Disposal of building rubbish / malba / similar unserviceable, dismantled or waste materials by mechanical means, including loading, transporting, unloading to municipal dumping ground beyond 50 m initial lead, for all leads including all lifts involved.	12	M.CUBE		
22	Dismantling doors, windows & C.S. windows shutter : Of area 3 sqm. including stacking the materials with all lead and lift	2	SQM		
REPAIR WORK					
	Special Repair Of Various Wooden window frames Including Polishing/ Painting And damaged wooden frame In Existing windows		LS		
1	Cleaning of entire roof before waterproofing application, complete with application of rust converter on rusted parts before application of the waterproofing membrane. Providing & laying water proofing treatment on roofs of slab by applying cement slurry mixed with water proofing cement compound Consisting of applying:	1.00	M.SQ		
PLUMBING					
<u>SANITARYWARE AND CP FITTINGS</u>					
	Note:1 Bidder may add items thought necessary at the end of this BOQ along with the quantities and rate.				

S. No	Description of work	Qty	Unit	Unit Rate in Rs.	Total Rate in Rs.
	<p>Note:2 Rates under Supply and Fixing will include (a). Cost of specified material with taxes and transporting to site, (b). stacking and storing them at site, (c.) Lead and lift to convey the materials within the site for installation of materials in their position as needed (d.) Cutting the masonry or concrete surfaces to facilitate fixing (e.) Restoring damaged portions to their original condition with supply of materials like cement, river sand, stone chips, brick etc. (f.) convey all the broken materials taken out of damaged portion within the toilet & shaft area by head load via staircase, to be dumped out of the work site for onward clearance by another agency (g.) all the works are to be carried out as per description mentioned against each item of work mentioned in schedule of quantities (h.) all tools and plants needed for the job to be brought in by the contractor at their cost including maintenance expenses, replacement at their cost wherever required – either in full or in part (i.) fixing materials like rackets, screws, bolts, nuts etc.</p>				
	<p>Supplying,installing,testing and commissioning of Parryware make cascade NXT range white/popular color wall mounted European Water closet with slim line dual flush cistern-"P" trap,Ultra solid seat cover with rubber buffers and flap including following accessories : brass screws with washer, pan connector, rag bolt/CI chair bracket with GI bolt and nuts etc.complete. Works including cutting and making good the walls /floor wherever required, including cost and conveyance of all materials to the site, all labour charges, all taxes etc., complete finished item of work and as directed by the SiteEngineer/Project In-Charge. The side gap between ewc mouth and pan connector to be filled with silicon sealant.</p>				
	<p>EWC-Wall mounted closet with"P"trap, Make-Parryware,Range-Cascade NXT,Model no-C0207</p>				

S. No	Description of work	Qty	Unit	Unit Rate in Rs.	Total Rate in Rs.
	Seat cover-Range-ultra solid seat cover,model no-C8140				
	Slim line economy dual flush pvc cistern model no: C8109				
	Pan Connector,Cp/Pvc connection tube				
	Wallvit pan fittings-C8015				
	15mm cp brass angular stop cock with wall flange-Jaquar - Continental-model no-CON-053				
	Sumo Chair Brackets-Parryware-C8166				
	Providing and fixing of cascade NXT White color EWC Wallvit pan set	1	Set		
	Supplying,Storing,Leading, Installing,Testing and commissioning of White Color Rectangular Wash basin . Works including following accessories; 32mm dia CP brass waste coupling, 32mm dia CP brass bottle trap with extension pipe, 15mm dia CP brass Angle valve, CP connections tupe, CP extention nipple, CP wall flange, Fisher bolt/Rag bolt, and necessary all hardware materials like brass screws, washer and nuts etc. complete. Works including necessary cutting and making finishing the wall and floors wherever required etc. complete.				
	Rectangular Wash basin -Parryware-Indus range-Size-550x450,model no:0471				
	CP waste coupling - Jaquar - Allied -Model no:705/709cp				
	CP Pillar cock with Auto closing system - PRS-031				
	CP bottle trap - Jaquar - Allied -Model no:769cp				
	15mm cp brass angular stop cock with wall flange-Jaquar - Continental-model no-CON-053				
	Cp connection tube,Rag bolt/bracket for basin				
	Providing and fixing of White color Rectangular wash basin set	QRO	Set		

S. No	Description of work	Qty	Unit	Unit Rate in Rs.	Total Rate in Rs.
	Supplying, Storing, Leading, Installing, Testing and commissioning of White Color Under Counter Oval Wash basin . Works including following accessories; 32mm dia CP brass waste coupling, 32mm dia CP brass bottle trap with extension pipe, 15mm dia CP brass Angle valve, CP connections tube, CP extension nipple, CP wall flange, basin brackets, and necessary all hardware materials like brass screws, washer etc. complete. Works including necessary cutting and making finishing the wall and floors wherever required etc. complete.				
	Oval Wash basin - Parryware - Cascade NXT - Size-550x450, model no: C0407				
	CP waste coupling - Jaquar - Allied -Model no:705/709cp				
	CP Pillar cock with Auto closing system - PRS-031				
	CP bottle trap - Jaquar - Allied -Model no:769cp				
	15mm cp brass angular stop cock with wall flange- Jaquar - Continental-model no-CON-053				
	Cp connection tube, Sumo bracket for basin				
	Providing and fixing of White Color Oval wash basin set	2	Set		
	Supplying and fixing of 15mm CP Pillar cock with Auto closing system for wash trough & etc. complete.				
	Jaquar-Pressmatic tap-model no:031	QRO	Each		
	Supplying and fixing 15mm CP Hand wash tap for wash basin (Floor mounted type) etc. complete.				
	Jaquar-florentine-model no:5357	QRO	Each		

S. No	Description of work	Qty	Unit	Unit Rate in Rs.	Total Rate in Rs.
	Supplying, Storing, leading ,installing,testing and commissioning Stainless steel sink with waste coupling - Single bowl with single drain board manufactured from high quality premium SS304 stainless steel, supporting bracket with screws etc.complete.Works including cutting and making good the walls /floor wherever required, including cost and conveyance of all materials to the site, all labour charges, all taxes etc., complete, finished item of work and as directed by the SiteEngineer/ In-Charge.				
	a)SS sink with Singlebowl with drain board-40"X20"-Bowl size:20"X16"X8"-Parryware-model no:8531,	QRO	Each		
	Supplying and fixing 15mm CP brass Sink cock with regular swinging spout(wall mounted) etc.complete				
	Sink cock-Jaquar-Florentine-model no:5347cp	QRO	Each		
	Supplying,installing, testing and commissioning of white color New magnum urinal with integrated spreader with cp connection pipe and elbow & nipple, waste coupling, 32mm bottle trap ,Fisher bolts/brackets,washers, screws etc.complete. Works including cutting and making good the walls /floor wherever required, cost including of conveyance of all materials to the site, all labour charges, complete.etc.complete				
	New magnum urinal - Parryware- 590x400x390 model no:0575				
	Parryware-Urinal spreader-C8095cp				
	Jaquar-Urinal Valve Auto Closing System with in built control cock-model no:077 cp				
	CP bottle trap,CP waste coupling - Jaquar - Allied-Model no:769,705/709				
	CP connection pipe,elbow & nipple				
	Providing and fixing of White Color New magnum Urinal set	QRO	Each		

S. No	Description of work	Qty	Unit	Unit Rate in Rs.	Total Rate in Rs.
	Supplying,installing,testing and commissioning of 15mm CP angle valve with flange including necessary screws for aqua guard etc.complete.				
	Angle valve-Jaquar-Continental-model no:053cp	QRO	Each		
	Supplying and fixing of CP brass angular stop cock with Health Faucet and 1 m flexible tube with wall hook,screws etc.complete.				
	Jaquar-Allied-model no:573cp				
	15mm cp brass angular stop cock with wall flange-Jaquar - Continental-model no-CON-053	2	Set		
	Supplying and fixing 15mm CP Long body bib tap with flange for janitor closet areas etc. complete.				
	Jaquar-continental-model no:107	QRO	Each		
	Supplying and fixing of Jaquar make 15mm CP short body bib tap with flange for ewc closet areas etc. complete.				
	CP Short body bib tap-Jaquar-Continental range-model no:037	QRO	Each		
	Supplying,instaling,testing and commissioning of electric water heater with CP angle valve, Conection tube swith wall flange, clamped to the wall etc. complete				
	30lit.capacity water heater-Racold ariston model-fibre body				
	15mm cp brass angular stop cock with wall flange-Jaquar - Continental-model no-CON-053	QRO	Each		
	Supplying and fixing Compact hand towell dispenser,accomadates 150 towels (Kimberly clark make) for wash basin fixing with necessary screws etc., complete				
	Compact towell dispenser(Pearl white)-01132;size-270X190X115mm				
	Kleenex multi fold towels-01221,1 packet=125 sheets	QRO	Each		

S. No	Description of work	Qty	Unit	Unit Rate in Rs.	Total Rate in Rs.
	Supplying and fixing of Jaquar make Soap dispenser with glass bottle for wash basin areas etc. complete.				
	Soap dispenser with glass bottle-Jaquar-Continental range-model no:ACN-1135N	2	Each		
	Supplying and fixing of Jaquar make cp Double coat hook fixing with necessary screws etc., complete				
	Jaquar-Kubix-model no:ACN-35761	2	Each		
	Supplying and fixing exposed type Toilet paper holder with out flap fixing with necessary screws etc., complete				
	Jaquar-continental-model no:1151N-cp	1	Each		
	Supplying and fixing cp Towel ring- fixing with necessary screws etc., complete				
	Jaquar-Continental-model no:1121BN	1	Each		
	Supplying and fixing cp Towel rod- fixing with necessary screws etc., complete				
	Jaquar-Continental-model no:1111cp	QRO	Each		
	Supplying, fixing and commissioning of Urinal Granite partition allround polished of size 450x900x18mm/20mm thick,(shape as per architectural drg)using 2 nos ss clamps embedded in 150 x 150 PCC pocket etc.complete	QRO	Each		
	Supplying and fixing of approved make 6mm thick mirror- 450 x 750 mm size for wash trough areas - with Teak wood frame and water proofed plywood backing, including polishing etc. complete	1	Each		
	INTERNAL DRAINAGE SYSTEM				

S. No	Description of work	Qty	Unit	Unit Rate in Rs.	Total Rate in Rs.
	<p>Rates under Supply and Fixing will include (a). Cost of specified material with taxes and transpoting to site, (b). stacking and storing them at site, (c.) Lead and lift to convey the materials with in the site for installation of materials in their position as needed (d.) Cutting the masonry or concrete surfaces to facilitate fixing (e.) Restoring damaged portions to their original condition with supply of materials like cement, river sand, stone chips, brick etc. (f.) convey all the broken materials taken out of damaged portion within the toilet & shaft area by head load via staircase, to be dumped out of the work site for onward clearance by another agency (g.) all the works are to be carried out as per description mentioned against each item of work mentioned in schedule of quantities (h.) all tools and plants needed for the job to be brought in by the contractor at their cost including maintenance expenses, replacement at their cost wherever required – either in full or in part (i.) fixing materials like rackets, screws, bolts, nuts etc.</p>				

S. No	Description of work	Qty	Unit	Unit Rate in Rs.	Total Rate in Rs.
	<p>Supplying, fixing and testing of approved make of 10kg PVC pipes confirming to IS 4985-2000. and fittings (moulded and fabriacted fittings) such as tee, elbow, 'y' , coupler, etc confirming to IS 7834 with latest amendment for soil and waste pipe works in toilets and utility area,basement storm water drain etc. Pipes shall be laid in sunken floors as per approved drawings with gradient mentined in the drawings with proper brick pedestal supprotts. For laying the pipes in walls, before chasing, the pipe line routing shall be marked using chaulk line with help of tupe level, wall cutting shall be done using wall cutting machine, and chasing to be done using electric jack hammer machine. Cutting and chasing with hammer shall not be permitteted. Pipes and fittings shall be cleaned with pipe cleaners and joined by approved approved make solvent cement. After laying the pipes, before cloasing tthe pipes, gravity test to be conducted and got the approval from the site engineers. chased portitions shall be covered with cement mortar. Work includes making required size holes in brick walls wherever necessary and re do same with water proofing components to the entire satisfaction of site engineer.etc complete. All the stub outs shall be closed with proper end caps till of installation of sanitraywares and accessories etc. complete.</p>				
	40mm dia Sch-80 upvc pipe for flush valve drain	6	RM		
	40mm dia	2	RM		
	50mm dia	6	RM		
	63mm dia	QRO	RM		

S. No	Description of work	Qty	Unit	Unit Rate in Rs.	Total Rate in Rs.
	<p>Supplying, fixing and testing of approved make of SWR - B- Class PVC pipes and fittings confirming to IS 13592-1992. and fittings (available fittings in market and fabricated fittings) such as tee, elbow, 'y' , coupler, etc. confirming to 14735 with latest amendment for soil and waste pipe works in toilets and utility area,etc. Pipes shall be laid in sunken for all floor toilets as per approved drawings with gradient mentioned in the drawings with proper supports. Wall cutting shall be done using wall cutting machine, and chasing to be done using electric jack hammer machine. Cutting and chasing with hammer shall not be permitted. Pipes and fittings shall be cleaned with pipe cleaners and joined by approved approved make solvent cement. After laying the pipes, before closing the pipes, gravity test to be conducted and got the approval from the site engineers. chased portions shall be covered with cement mortar. Work includes making required size holes in brick walls wherever necessary and re do same with water proofing components to the entire satisfaction of site engineer.etc complete. All the stub outs shall be closed with proper end caps till of installation of sanitarywares and accessories etc. complete.</p>				
	75mm dia	6	RM		
	110mm dia	6	RM		
	<p>Providing and Laying Plain cement concrete (1:4:8) encasing for internal pipes laid in sunken floor, 100mm thick around the pipes with the help of necessary wooden shuttering etc. complete.</p>				
	75 to 110mm dia	QRO	M3		

S. No	Description of work	Qty	Unit	Unit Rate in Rs.	Total Rate in Rs.
	Fabricating, supplying, and fixing of Truebore make 4mm wall thickvess uPVC Floor traps, made out of 110mm dia PVC Pipe with single or multiple inlets of size 40mm to 75mm dia.(boss tee connections), outlets of sizes 63 mm to 75mm, with min.2" water seal, fixing in position, using cement concrete 100 mm alround to full depth of trap/suspended in ceiling level with proper supports, including providing FRP matting at bottom, inlet and outlet etc, complete.	3	Each		
	Supplying,fixing and testing of PVC 'P' trap 110mm dia extension boss tee arrangements with female thread fix with the Staninless steel heavy duty clean out in male thread with gascet and three ss screws/PVC heavy duty clean out for urinals, etc., complete	2	Nos		
	Supplying,fixing and testing of Heavy duty Floor Clean Out which are provided in floors slab ,with female thread fix with the SS/Pvc heavy duty clean out plug in male thread with gasket and 110mm dia boss tee arrangements etc. complete				
	75 mm dia	1	Nos		
	110 mm dia	1	Nos		
	Drilling with core cutting in RCC beams, slabs, floors etc.,for laying pipes and rendering the same in RCC 1:2:4, finishing the same to the satisfaction of the Owner or his authorized representative etc.,including nominal reinforcement where ever required, complete. The quoted rate shall also include for providing EPOXY based water proofing compound for sealing the joints around the pipes. Core cut shall be done using rebar detector after getting the approval from the structural consultant..				
	a) RCC beams				
	25mm dia upto 50 mm	QRO	Each		
	50mm dia upto 110 mm	QRO	Each		
	110mm dia. upto 160 mm	QRO	Each		

S. No	Description of work	Qty	Unit	Unit Rate in Rs.	Total Rate in Rs.
	160mm upto 250mm	QRO	Each		
	Fabricating brackets using Mild Steel flats or angles, cutting, welding, forming shapes, providing hot dip galvanizing for brackets, cutting pockets in masonry / concrete surfaces, grouting brackets in concrete of 1:2:4 mix, restoring the damaged portion to their original condition required materials etc. complete.	100	Kg		
	Supplying and fixing of pvc grating of approved make, fixed over the floor trap. Works including cleaning of floor traps before fixing the gratings. While fixing the gratings, flooring should be cutted to required size of grating,(not more than 2mm of the grating sizes) using tile cutter etc. complete. The gap should be filled with colored white cement to match the flooring colour. The colour and shape of the gratings shall be got the approval from the architects/consultants	4	Each		
	Supplying and fixing of Chilly make CP Anti cockroach floor trap gratings which consisting floor drain grating, inner filter and outfilter and rim , fixed over the floor trap. Works including cleaning of floor traps before fixing the gratings. While fixing the gratings, flooring should be cutted to required size of grating,(not more than 2mm of the grating sizes) using tile cutter etc. complete. The gap should be filled with colored white cement to match the flooring colour. The colour and shape of the gratings shall be got the approval from the architects/consultants. To avoid damage of the cp gratings, acid cleaning of flooring shall be done before fixing of gratings.	QRO	Each		
	<u>WATER SUPPLY SYSTEM</u>				
	<u>(Internal water supply with in Toilet)</u>				

S. No	Description of work	Qty	Unit	Unit Rate in Rs.	Total Rate in Rs.
	<p>Supplying, fixing and testing of approved make uPVC pipe - SCH 80 grade-pipes and same fittings. Using Schedule-80 pipes are confirming to ASTM D-1785 and SCH-80 fittings are confirming to ASTM D-2467,Solvent cement is confirming to ASTM D 2564, for Domestic water supply within the toilets areas, kitchen and pantry areas - Concealing in walls & ledge walls, with necessary fittings such as tee,elbow,union,nipple. including brass moulded fittings, brass male/female adapters etc., .,including cutting and jointing using uPVC solvent cement as per manufacturer's recommendation ,chasing the wall and fixing the pipe with proper clamp supports, redoing the same, and fixed properly, ceiling level and running in sunken floor level with proper pipe supports etc. complete.Works also include to provide bitumen painted hessain cloth insulation on buried pipes etc...complete.Works to include necessary identification marks,flow direction marks on the pipes which are visible ,exposed lines.Pipes mounted on the necessary paver block supports,refilling by sand etc complete.Works include excavation in all sorts of soils, laying the pipe, provide sand cushion all around the pipes, and refilling the same.</p>				
	Internal water supply:				
	<p>Making of water supply pipes connected with the fittings by uPVC solvent cement as per the drawing routing, pipes chasing in the wall, running in sunken floors/suspended in ceiling level with proper clamp pipe Supports with in the toilets,kitchen,pantry,hand wash,plate wash and service areas.Works including cutting in the wall,floors and necessary areas and refilling the same.</p>				
	Testing:				

S. No	Description of work	Qty	Unit	Unit Rate in Rs.	Total Rate in Rs.
	All water supply pipes undergo testing to withstand the necessary hydraulic pressure (7 kg/cm ²) for 24 hr etc complete.				
	3/4" dia (ID)	7	RM		
	1" dia (ID)	7	RM		
	1 1/4" dia (ID)	7	RM		
	1 1/2" dia (ID)	QRO	RM		
	Supplying, fixing and testing of approved make hot forged and sand blasted Brass ball valve with full port, Silicon free, double viton O-ring stem seal, Dacrotized carbon steel handle and nickel plated stem, teflon ball seat on both sides, forged brass hard chrome plated steel ball tested to a pressure not less than 15kg/sqcm with threaded / flanged joints complete with nuts, bolts, gaskets, washers, mta and union etc complete.				
	20mm dia	0	Each		
	25mm dia	1	Each		
	32mm dia	3	Each		
	40mm dia	QRO	Each		
	Supplying, fixing of approved make Brass 'Y' strainer on delivery line with necessary accessories etc., complete				
	50mm dia	QRO	Each		
	Supplying, fixing and testing of approved make C.I Wafer type Check valve etc. complete				
	40mm dia	QRO	Each		
	Fabricating and fixing pipe inserts with water bar making in Sch-80 pvc pipe 5mm thick, Pvc square plate around 1" of pipe perimeter to over head water tank etc. complete				
	25mm dia	QRO	Each		
	40mm dia	QRO	Each		
	50mm dia	QRO	Each		
	65mm dia	QRO	Each		
	EXTERNAL DRAINAGE & WATER SUPPLY				

S. No	Description of work	Qty	Unit	Unit Rate in Rs.	Total Rate in Rs.
	Supplying, laying, testing and commissioning approved make of SWR PVC- B Class pipe for 75/110/160 mm dia confirming to IS 13592-1992 and 6kg UPVC Pipes for 200/250/315/400 mm dia confirming to IS 4985 - 2000 for underground drainage and sewerage systems - pipes in trenches to required gradients and burried in ground level etc., complete. Rates to include excavation in all kinds/types of soils including hard laterites but except hardrock for laying pipes,,forming bottom surface to required level, refilling selected excavated earth around the encasing, watering, consolidating and disposing off the surplus earth with in the site or as directed by the site engineer etc., Works included pumping out water from trenches with shoring wherever necessary.External sewage pipes are burried in ground level from inspection chamber to inspection chamber,finally goes to sewage collection well.Using solvent cement joints for jointing the pipes with fittings like coupler,elbow,bend and fabricated fittings etc complete.				
	110mm dia - 500 to 1000 depth	10	RM		
	160mm dia - 500 to 1000 depth	1	RM		
	160mm dia - 1000 to 1500 depth	QRO	RM		
	160mm dia - 1500 to 2000 depth	QRO	RM		
	Providing pcc encasing for all external pipes with laying cement concrete 1:3:6 mix using 6mm jelly casing all round the pipes etc., complete				
	110mm to 160mm dia	1	RM		

S. No	Description of work	Qty	Unit	Unit Rate in Rs.	Total Rate in Rs.
	Construction of inspection chambers in brick work as per the following specification. Earth work excavation in all type of soil except hard rock with initial lead and lift, river sand filling, P.C.C.1:4:8 for foundation using 40 mm metal jelly, R.C.C.1:1.5:3 using 20 mm metal jelly for foundation bed concrete thickness as per the drawing, Brick work in CM 1:4 mix for walls thickness as per the drawing given, work including scaffolding ,shuttering charges for all R.C.C.works, wall plastering with CM 1:3, mix 15 mm thick for inside and outside wall. bed benching with P.C.C.1:2:4 mix using 20 mm metal jelly, thickness as per the drawing given. over the bed benching water proof compound mix plastering in CM 1:3 , 15 mm thickness.				
	Necessary cover slab to be laid in R.C.C.1:1.5:3, with manhole cover provision (SFRC cover-600X600 Heavy duty and 600 dia Round heavy duty), P.V.C. insulated footrest to be provided 300 mm c/c as per the drawing. Reinforcement for R.C.C. bed and wall is 12 mm TMT bars 150 mm C/C on both ways and both faces of concrete. Earth backfilling to be done after completion of all works with selected earth with water consolidation.				
	450x450 depth upto 1000 from the Formed Ground level as shown in the drawing	QRO	Each		
	600x600 depth upto 1000 from the Formed Ground level or Finished Road level as shown in the drawing	QRO	Each		
	900x600 depth from 1000 to 1500 from the Formed Ground level or Finished Road level as shown in the drawing	QRO	Each		
	900x750 depth from 1500 to 2000 from the Formed Ground level or Finished Road level as shown in the drawing	QRO	Each		

S. No	Description of work	Qty	Unit	Unit Rate in Rs.	Total Rate in Rs.
	Construction of gully chamber with pvc gully with CI grating set in 75mm thick PCC 1:4:8 bed, in 115mm thick masonry chamber in CM 1:4, internal and external plastering 12mm thick in CM 1:6, supply and fixing 300x300 SFRC cover slab and frame, including excavating, refilling etc., complete				
	300x300	QRO	Each		
	Construction of Oil & Crease chamber with best quality bricks to 230mm thick in CM 1:4 over a bed of 200mm thick PCC 1:4:8, wall plastered CM 1:3 inside and out side, including 700X550x50mm thick, RCC baffle wall, provide 575x575x300 perforated bucket made by Pvc, as shown in detail drawings, provide 6mm MS chequered plate cover in two pieces with lifting hook fixed on 40x40x5 MS frame, encapsulated rungs, necessary excavation and refilling etc. complete				
	size 1750x600x600 (liquid depth)	QRO	Each		
	Making connection to the Existing sewer line , works including necessary pipes, fittings, and cutting the wall of existing IC and making good the road after connection.	1	LS		
	Constructing brick masonry chamber (for housing valves, meters etc) of brick work with bricks of class 75 with cement mortar 1:5 (1 cement:5 fine sand) plastering internal face with cement mortar 1:3 (1 cement:3 fine sand) and rough plaster on outer face with a floating coat of neat cement. R.C.C top slab with medium duty SFRC cover of 600X600mm size. Including excavation, dewatering, refilling, watering, ramming and removing the surplus excavated material complete as required. (All sizes are clear internal sizes)				
	600x600 depth upto 1000	QRO	Nos		
	900x800 depth upto 1000	QRO	Nos		

S. No	Description of work	Qty	Unit	Unit Rate in Rs.	Total Rate in Rs.
	Supplying, laying ,fixing and testing of approved make uPVC - SCH-80 of High Pressure upvc Domestic Water Supply System with same specials like coupler elbow ,bend and Tee etc complete.Using sovent cement for jointing pipes and specials etc.complete. pipes burried in the ground level, .. (cost including earth work excavation)				
	1"dia (ID)	6	RM		
	1 1/4"dia (ID)	1	RM		
	1 1/2"dia (ID)	QRO	RM		
	Making connection to the External main water line of dws, fws, works including necessary pipes, fittings, and cutting the main road/landscaped area and making good the road after connection.	1	Each		
ALUMINUM WORK					
6	Providing and fixing aluminum work for doors, windows, ventilators and partitions with extruded built up standard tubular sections/ appropriate Z sections and other sections of approved make conforming to IS: 733 and IS: 1285, fixing with dash fasteners of required dia and size, including necessary filling up the gaps at junctions, i.e. at top, bottom and sides with required EPDM rubber/ neoprene gasket etc. Aluminum sections shall be smooth, rust free, straight, mitred and jointed mechanically wherever required including cleat angle, Aluminum snap beading for glazing / paneling, C.P. brass / stainless steel screws, all complete as per architectural drawings and the directions of Engineerin-charge. (Glazing, paneling and dash fasteners to be paid for separately): For fixed portion. Anodized aluminum (anodized transparent or dyed to required shade according to IS: 1868, Minimum anodic coating of grade AC 15). The rate should also includes providing PU sealent in both inside and outside	0.02	MT		

S. No	Description of work	Qty	Unit	Unit Rate in Rs.	Total Rate in Rs.
	S/F 100mm brass lock for aluminium door including necessary cutting and making good etc. complete	1.00	EACH		
	Providing and fixing aluminium tower bolts (100*10mm) ISI marked anodised (anodic coating not less than grade AC 10 as per IS : 1868) transparent or dyed to required colour or shade with necessary screws etc. complete :	4.00	EACH		
	Providing and fixing glazing in aluminum door, window, ventilator shutters and partitions etc. with EPDM rubber / neoprene gasket etc. complete as per the architectural drawings and the directions of Engineer-in- Charge. (Cost of aluminum snap beading shall be paid in basic item): With float glass panes of 5.5 mm thickness.	2.00	SQM		
	Providing and fixing aluminum extruded section body tubular type universal hydraulic door closer (having brand logo with ISI, IS : 3564, embossed on the body, door weight up to 36 kg to 80 kg and door width from 701 mm to 1000 mm), with double speed adjustment with necessary accessories and screws etc. complete	QRO	EACH		
	Providing and fixing aluminum tubular handle bar 32 mm outer dia, 3.0 mm thick & 2100 mm long with SS screws etc. complete as per direction of Engineerin-Charge. Anodized (AC 15) aluminum tubular handle bar	4.00	EACH		
	Providing and fixing aluminium hanging floor door stopper ISI marked anodised (anodic coating not less than grade AC 10 as per IS : 1868) transparent or dyed to required colour and shade with necessary screws etc. complete. With twin rubber stopper	2.00	EACH		

S. No	Description of work	Qty	Unit	Unit Rate in Rs.	Total Rate in Rs.
	Providing and fixing double action hydraulic floor spring of approved brand and manufacture IS : 6315 marked, for doors including cost of cutting floors as required, embedding in floors and cover plates with brass pivot and single piece M.S. sheet outer box with slide plate etc. complete as per the direction of Engineer-in-charge. With Brass cover Plate	QRO	EACH		
	P/F IS : 3564 marked Aluminium die cast tubular type universal hydraulic door closer complete. <u>x000D</u>	4.00	EACH		
	Providing and fixing 12 mm thick pre laminated particle board flat pressed three layer or graded wood particle board conforming to IS: 12823 Grade I Type II, in paneling fixed in aluminum doors, windows shutters and partition frames with C.P. brass / stainless steel screws etc. complete as per architectural drawings and directions of Engineer-inCharge. Pre-laminated particle board with decorative lamination on both sides	2.00	SQM		
	Total				

SEAL OF THE TENDERER

SIGNATURE
NAME AND ADDRESS OF TENDERER

SECTION XI

HLL LIFECARE LIMITED
AKKULAM FACTORY, THIRUVANANTHAPURAM-695017
Ph: 0471 244 5930 /244 2642
hcdcmo@lifecarehll.com

**RENOVATION OF LABOUR ROOM AT POST GRADUATE AYURVEDIC
COLLEGE, PAPROLA**
(ELECTRICAL WORKS)

PRICE SCHEDULE (b)

Sl. No	Description of work	Unit	Qty	Unit Rate in Rs.	Total Rate in Rs.
1	Point wiring in PVC conduit with modular type switch.				
	Wiring for light point/fan point/exhaust fan point /call bell point with 1.5 sq mm FR PVC insulated copper conductor single core cable in surface/recessed medium class PVC conduit, with modular switch, modular plate, suitable PVC box and earthing the point with 1.5 sq.mm FR PVC insulated copper conductor single core cable etc as required.				
	Group C	Point	30		
2	Wiring through PVC conduit				
	Wiring for circuit/submain wiring along with earth wire with the following sizes of FR PVC insulated copper conductor, single core cable in surface/recessed medium class PVC conduit as required.				
	2X1.5 sq.mm + 1X1.5 sq.mm earth wire	Metre	155		
	2X2.5 sq.mm + 1 X2.5 sq mm earth wire	Metre	290		
	2X4 sq.mm + 1X4 sq.mm earth wire	Metre	195		
3	A/C point				

Sl. No	Description of work	Unit	Qty	Unit Rate in Rs.	Total Rate in Rs.
	S/F 20A SPN MCB industrial socket outlet: Supplying and fixing 20 amps, 240 volts, SPN industrial type, socket outlet, with 2 pole and earth, metal enclosed plug top alongwith 20 amps "C" curve, SP, MCB, in sheet steel enclosure, on surface or in recess, with chained metal cover for the socket out let and complete with connections, testing and commissioning etc. as required.	Point	3		
4	Modular boxes, bases & cover plate: Supplying and fixing following size/modules, PVC box along with modular base & cover plate for modular switches in recess etc as required.(Make: Legrand))				
	3 module	Each	10		
	6 module	Each	18		
5	Modular type blanking plate: Supplying and fixing modular blanking plate on the existing modular plate & switch box excluding modular plate as required.	Each	10		
6	Modular type switch/socket: Supplying and fixing following modular switch/socket on the existing modular plate & switch box including connections but excluding modular plate etc as required.(Make: Legrand))				
	5/6 Amps switch	Each	27		
	3 pin 5/6 Amp socket outlet	Each	27		
	15/16 Amps switch	Each	18		
	6pin 15/16 Amps (universal) socket outlet	Each	18		
	Telephone Socket	Each	1		
7	S/F PVC conduit: Supplying and fixing of following sizes of medium class PVC conduit along with accessories in surface/recess including cutting the wall and making good the same in case of recessed conduit as required.				
	20 mm	Metre	150		

Sl. No	Description of work	Unit	Qty	Unit Rate in Rs.	Total Rate in Rs.
8	ITC Fluorescent fitting directly on surface: Installation, testing and commissioning of pre-wired, fluorescent fitting / compact fluorescent fitting of all types, complete with all accessories and tube etc. directly on ceiling/ wall, including connection with 1.5 sq. mm FR PVC insulated, copper conductor, single core cable and earthing etc. as required.	Each	13		
9	CABLE LAYING				
	Wiring for circuit/ submain wiring along with earth wire with the following sizes of FR PVC insulated copper conductor, single core cable in surface/ recessed medium class PVC conduit as required.				
a	From EB MAIN to DG				
	2 X 10 sq. mm + 1 X 10 sq. mm earth wire	Metre	35		
b	From DG MAIN to DB				
	2 X 10 sq. mm + 1 X 10 sq. mm earth wire	Metre	45		
10	END TERMINATION				
	Supply and making end termination with brass compression gland, earth clip and aluminium lugs for following size of cables as required.				
a	2 X 10 sq.mm	Each	4		
11	Installation, testing and commissioning of ceiling /wall fan, including wiring the down rods of standard length (upto 30 cm) with 1.5 sq. mm FRLS PVC insulated, copper conductor, single core cable etc. as required.	Each	6		
12	Supplying and fixing stepped type electronic fan regulator on the existing modular plate switch box including connections but excluding modular plate etc. as required.	Each	6		
13	Angle batten (including CFL)				
	Supplying and fixing PVC angle batten/batten holder with 15W LED LAMP (Make: Havells/Philips) including connection as required.	Each	0		

Sl. No	Description of work	Unit	Qty	Unit Rate in Rs.	Total Rate in Rs.
14	Supply of ceiling fan 1200 mm sweep, double ball bearing, approved colour and quality with original down rod,suspension shackle,canopy etc with out regulator complete with all accessories as required.In case of any problem for fixing ceiling fan supply 400mm wall fan with price equal to ceiling fan)	Each	6		
15	Supply of 1x28W flourescent tube fitting sleek with decorative end cap, powder coated CRCA steel channel complete with all electrical accessories like electronic ballast, lamp holder, 28W T5 lamp etc complete as required. (Philips TMS 540 HF / Wipro WRF 80128 SG / GE DMS 28 N N)	Each	3		
16	Supply and installation of 2x36W recess mounted, decorative Soft lite luminaire, powder coated CRCA housing complete with all electrical accessories like electronic ballast, lamp holder, 36W CFL lamp etc complete with all mounting accessories like chain, anchor fastner etc as required. (Havells2x36 WFP-L (HF) ordering code: LHE CDEG21N1W036)/Bajaj BMLA 101 236 CFL WEB2 ordering product code 538926) .or else change may be approved as per the direction of engineer in HLL/NHM	Each	10		
17	S/F SP & N DB:				
	Supplying and fixing following way prewired SP&N MCB, distribution board of steel sheet for 240 volts on surface/recess complete with loose wire box, terminal connectors for all incoming and outgoing circuits, duly prewired with suitable size FR PVC insulated copper conductor up to terminal blocks, tinned copper bus bar, neutral link, earth bar, detachable gland plate, interconnections, powder painted including earthing etc.as required(But without MCB/RCCB/Isolator) (Make: Legrand/ Havells/ HPL)				
	8 way SPN, double door	Each	1.00		
	12 way SPN, double door	Each	1.00		
17.1	S/F of DP ISOLATOR				

Sl. No	Description of work	Unit	Qty	Unit Rate in Rs.	Total Rate in Rs.
	Supplying and fixing following rating, double pole, (single phase and neutral), 240 volts, ISOLATOR having a sensitivity current upto 100 to 300 milliamperes in the existing MCB DB complete with connections, testing and commissioning etc, as required.(Make: Legrand/ Havells/ HPL)				
	40 A, DP isolator	Each	2.00		
17.2	S/F of SP MCB				
	Supplying and fixing 6 amps to 32 amps rating, 240 Volts, "C" series, miniature circuit breaker suitable for lighting and other loads of following poles in the existing MCB DB complete with connections, testing and commissioning etc as required.(Make: Legrand/Havells/HPL)				
	6/32 A SP MCB	Each	16		
18	Supply and pointing exhaust fan shutter type white colour-9"/10"(Make Havells/Bajaj/Almonard)	Each	3		
19	Supply and Fixing of Calling bell with its all accessories(ISI Branded)	Each	3		
20	WORK COMPLETION				
	Miscellaneous Items				
	Miscellaneous electrical work, removing of existing conduits and interconnections of light,6A socket/16A socket/A/C point from existing DB	LS	1		
	Total				

SEAL OF THE TENDERER

SIGNATURE
NAME AND ADDRESS OF TENDERER

CIVIL DRAWING

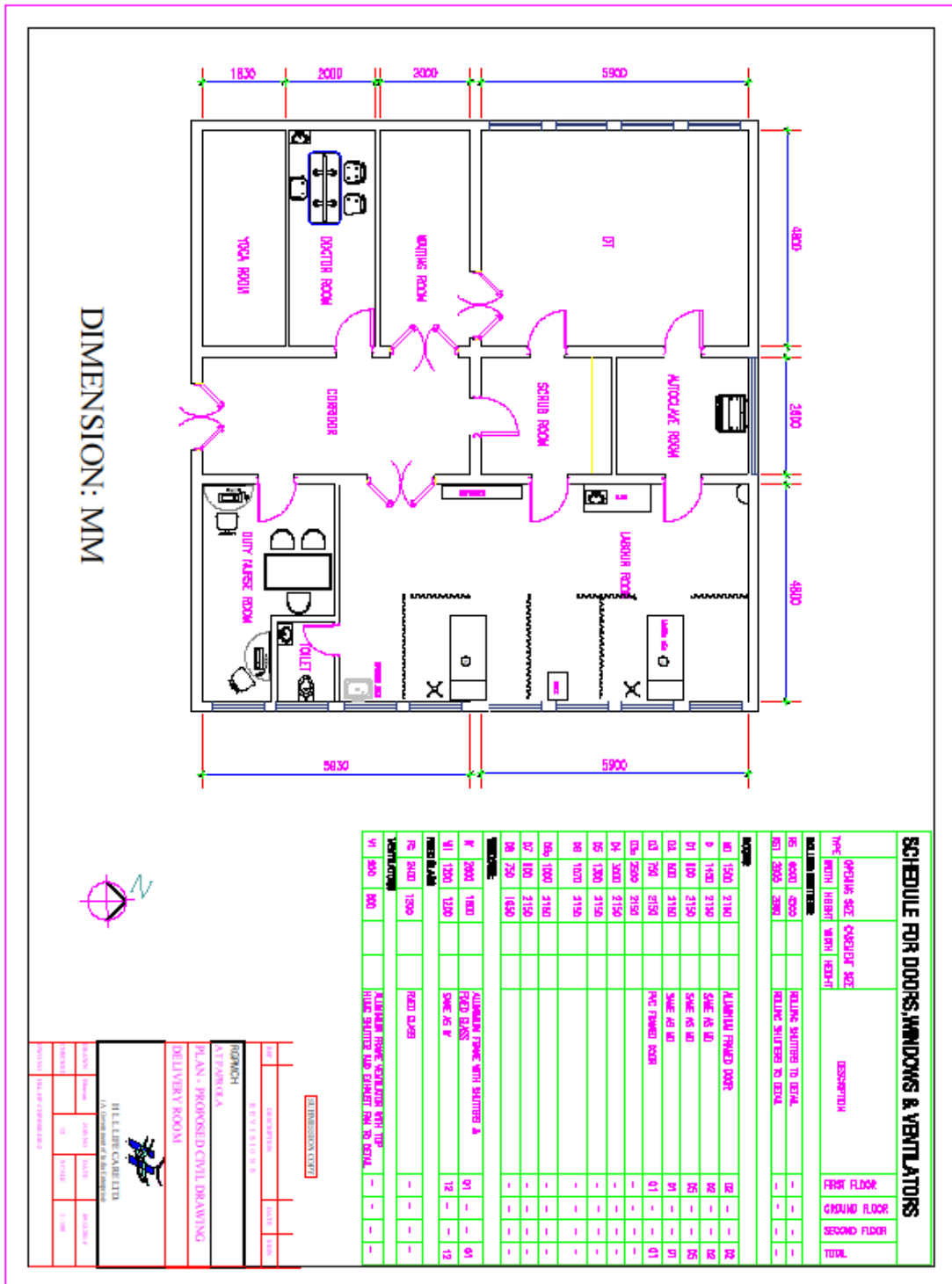

SCHEDULE FOR DOORS, WINDOWS & VENTILATORS				FIRST FLOOR	GROUND FLOOR	SECOND FLOOR	TOTAL
NO	DESCRIPTION	QTY	UNIT				
01	ALUMINIUM FRAMED DOOR	01		-	-	-	01
02	ALUMINIUM FRAMED DOOR	02		-	-	-	02
03	ALUMINIUM FRAMED DOOR	05		-	-	-	05
04	ALUMINIUM FRAMED DOOR	01		-	-	-	01
05	ALUMINIUM FRAMED DOOR	01		-	-	-	01
06	ALUMINIUM FRAMED DOOR	01		-	-	-	01
07	ALUMINIUM FRAMED DOOR	01		-	-	-	01
08	ALUMINIUM FRAMED DOOR	01		-	-	-	01
09	ALUMINIUM FRAMED DOOR	01		-	-	-	01
10	ALUMINIUM FRAMED DOOR	01		-	-	-	01
11	ALUMINIUM FRAMED DOOR	01		-	-	-	01
12	ALUMINIUM FRAMED DOOR	01		-	-	-	01
13	ALUMINIUM FRAMED DOOR	01		-	-	-	01
14	ALUMINIUM FRAMED DOOR	01		-	-	-	01
15	ALUMINIUM FRAMED DOOR	01		-	-	-	01
16	ALUMINIUM FRAMED DOOR	01		-	-	-	01
17	ALUMINIUM FRAMED DOOR	01		-	-	-	01
18	ALUMINIUM FRAMED DOOR	01		-	-	-	01
19	ALUMINIUM FRAMED DOOR	01		-	-	-	01
20	ALUMINIUM FRAMED DOOR	01		-	-	-	01
21	ALUMINIUM FRAMED DOOR	01		-	-	-	01
22	ALUMINIUM FRAMED DOOR	01		-	-	-	01
23	ALUMINIUM FRAMED DOOR	01		-	-	-	01
24	ALUMINIUM FRAMED DOOR	01		-	-	-	01
25	ALUMINIUM FRAMED DOOR	01		-	-	-	01
26	ALUMINIUM FRAMED DOOR	01		-	-	-	01
27	ALUMINIUM FRAMED DOOR	01		-	-	-	01
28	ALUMINIUM FRAMED DOOR	01		-	-	-	01
29	ALUMINIUM FRAMED DOOR	01		-	-	-	01
30	ALUMINIUM FRAMED DOOR	01		-	-	-	01
31	ALUMINIUM FRAMED DOOR	01		-	-	-	01
32	ALUMINIUM FRAMED DOOR	01		-	-	-	01
33	ALUMINIUM FRAMED DOOR	01		-	-	-	01
34	ALUMINIUM FRAMED DOOR	01		-	-	-	01
35	ALUMINIUM FRAMED DOOR	01		-	-	-	01
36	ALUMINIUM FRAMED DOOR	01		-	-	-	01
37	ALUMINIUM FRAMED DOOR	01		-	-	-	01
38	ALUMINIUM FRAMED DOOR	01		-	-	-	01
39	ALUMINIUM FRAMED DOOR	01		-	-	-	01
40	ALUMINIUM FRAMED DOOR	01		-	-	-	01
41	ALUMINIUM FRAMED DOOR	01		-	-	-	01
42	ALUMINIUM FRAMED DOOR	01		-	-	-	01
43	ALUMINIUM FRAMED DOOR	01		-	-	-	01
44	ALUMINIUM FRAMED DOOR	01		-	-	-	01
45	ALUMINIUM FRAMED DOOR	01		-	-	-	01
46	ALUMINIUM FRAMED DOOR	01		-	-	-	01
47	ALUMINIUM FRAMED DOOR	01		-	-	-	01
48	ALUMINIUM FRAMED DOOR	01		-	-	-	01
49	ALUMINIUM FRAMED DOOR	01		-	-	-	01
50	ALUMINIUM FRAMED DOOR	01		-	-	-	01
51	ALUMINIUM FRAMED DOOR	01		-	-	-	01
52	ALUMINIUM FRAMED DOOR	01		-	-	-	01
53	ALUMINIUM FRAMED DOOR	01		-	-	-	01
54	ALUMINIUM FRAMED DOOR	01		-	-	-	01
55	ALUMINIUM FRAMED DOOR	01		-	-	-	01
56	ALUMINIUM FRAMED DOOR	01		-	-	-	01
57	ALUMINIUM FRAMED DOOR	01		-	-	-	01
58	ALUMINIUM FRAMED DOOR	01		-	-	-	01
59	ALUMINIUM FRAMED DOOR	01		-	-	-	01
60	ALUMINIUM FRAMED DOOR	01		-	-	-	01
61	ALUMINIUM FRAMED DOOR	01		-	-	-	01
62	ALUMINIUM FRAMED DOOR	01		-	-	-	01
63	ALUMINIUM FRAMED DOOR	01		-	-	-	01
64	ALUMINIUM FRAMED DOOR	01		-	-	-	01
65	ALUMINIUM FRAMED DOOR	01		-	-	-	01
66	ALUMINIUM FRAMED DOOR	01		-	-	-	01
67	ALUMINIUM FRAMED DOOR	01		-	-	-	01
68	ALUMINIUM FRAMED DOOR	01		-	-	-	01
69	ALUMINIUM FRAMED DOOR	01		-	-	-	01
70	ALUMINIUM FRAMED DOOR	01		-	-	-	01
71	ALUMINIUM FRAMED DOOR	01		-	-	-	01
72	ALUMINIUM FRAMED DOOR	01		-	-	-	01
73	ALUMINIUM FRAMED DOOR	01		-	-	-	01
74	ALUMINIUM FRAMED DOOR	01		-	-	-	01
75	ALUMINIUM FRAMED DOOR	01		-	-	-	01
76	ALUMINIUM FRAMED DOOR	01		-	-	-	01
77	ALUMINIUM FRAMED DOOR	01		-	-	-	01
78	ALUMINIUM FRAMED DOOR	01		-	-	-	01
79	ALUMINIUM FRAMED DOOR	01		-	-	-	01
80	ALUMINIUM FRAMED DOOR	01		-	-	-	01
81	ALUMINIUM FRAMED DOOR	01		-	-	-	01
82	ALUMINIUM FRAMED DOOR	01		-	-	-	01
83	ALUMINIUM FRAMED DOOR	01		-	-	-	01
84	ALUMINIUM FRAMED DOOR	01		-	-	-	01
85	ALUMINIUM FRAMED DOOR	01		-	-	-	01
86	ALUMINIUM FRAMED DOOR	01		-	-	-	01
87	ALUMINIUM FRAMED DOOR	01		-	-	-	01
88	ALUMINIUM FRAMED DOOR	01		-	-	-	01
89	ALUMINIUM FRAMED DOOR	01		-	-	-	01
90	ALUMINIUM FRAMED DOOR	01		-	-	-	01
91	ALUMINIUM FRAMED DOOR	01		-	-	-	01
92	ALUMINIUM FRAMED DOOR	01		-	-	-	01
93	ALUMINIUM FRAMED DOOR	01		-	-	-	01
94	ALUMINIUM FRAMED DOOR	01		-	-	-	01
95	ALUMINIUM FRAMED DOOR	01		-	-	-	01
96	ALUMINIUM FRAMED DOOR	01		-	-	-	01
97	ALUMINIUM FRAMED DOOR	01		-	-	-	01
98	ALUMINIUM FRAMED DOOR	01		-	-	-	01
99	ALUMINIUM FRAMED DOOR	01		-	-	-	01
100	ALUMINIUM FRAMED DOOR	01		-	-	-	01

ELECTRICAL DRAWING

