

Sym.	Descr.
	SWITCH BOARD
	5 A / 6 A LIGHT PLUG
	20 A TPN POWER SOCKET
	5/6 A SOCKET OUT-LET UPS 2NOS. WITH 1 NO. 16 A SOCKET OUT-LET
	15/16 A SOCKET OUT
	CCTV CAMERA
	600 X 600 RECESS LIGHT
	DATA & TELEPHONE OUTLET
	DISTRIBUTION BOX
	UPS BOX

NOS.	DATE	DESCRIPTION	OWN	CKD.	
R E V I S I O N S					

CLIENT



PROJECT TITLE
PROPOSED AMRIT PHARMACY AT RIMS,IMPHAL

CLIENT'S SIGNATURE

ARCHITECT'S SIGNATURE

DRAWING TITLE
PROPOSED AMRIT PHARMACY AT RIMS IMPHAL ELECTRICAL LAYOUT

DATE: 26-02-2016

SCALE = 1:100

DRG. NUMBER

AMR/ IMP/003

REV

00

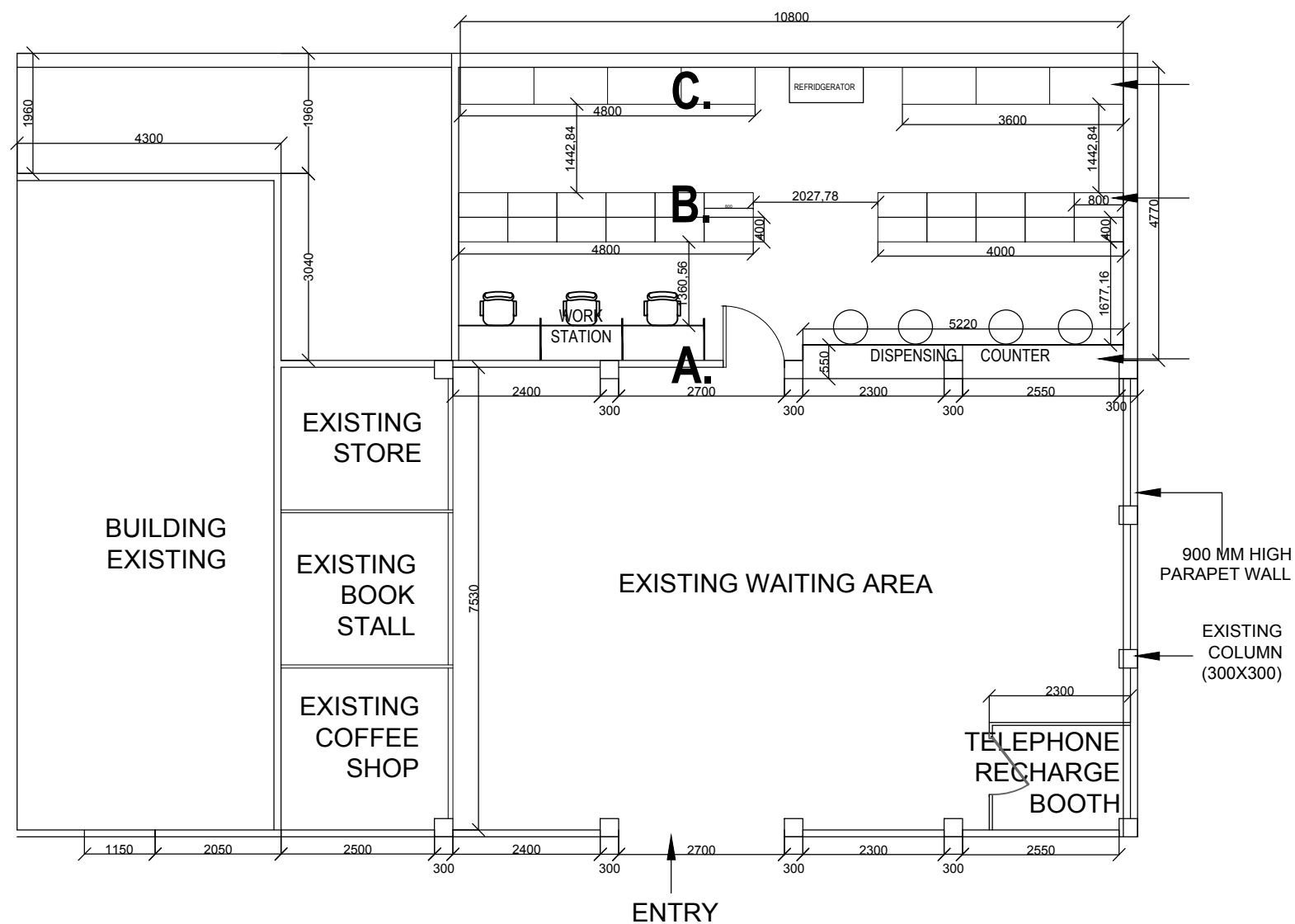

(A) 850 mm high dispensing counter.
12mm thick acrylic sheet to be used for counter
on 20mm thick commercial ply. Display unit with
18 mm thick prelaminated shelves to be inbuilt in
counter as/design.

(B.) 900 mm high storage unit with laminated top. 400 mm deep prelaminated storage unit with 18mm thick prelaminated shelves and shutters fixed with auto hinges to be provided.

(C.) 2400 mm high storage unit.
400 mm deep prelaminated storage unit with 18mm thick prelaminated shelves and shutters fixed with auto hinges to be provided. The ht. of 600mm deep storage shall be 750mm. 400mm deep storage unit to be fixed between two 150mm wide laminated facia. 400 mm wide 10mm thick toughened glass shelves to be fixed with aluminum channel and adjustable holders till 2100mm. In built overhead unit of 400mm depth 350 mm height to be fixed above 2100mm ht. as /design

NOS.	DATE	DESCRIPTION	DWN	CKD.

R E V I S I O N S				
-------------------	--	--	--	--

CLIENT _____

SCIENT	
--------	--

LITES
FILES
HLL INRATECH SERVICES LTD

ALL INFORMATION SERVICES LTD

PROJECT TITLE

PROPOSED AMBITPHARMACY AT BIMS IMPHALPHARMACT AT TMS, INITIAL

CLIENT'S SIGNATURE	ARCHITECT'S SIGNATURE
--------------------	-----------------------

[illegible][illegible][illegible][illegible][illegible]

--	--

DRAWING TITLE

DRAWING TITLE
PROPOSED AMBIT PHARMACY

AT BIMS IMPHALLAYOUT PLAN

LAYOUT PLAN

DATE: 23-02-2016	SCALE = 1:150
------------------	---------------

DRG. NUMBER	REV
-------------	-----

AMR/IMP/001	00
-------------	----

/XIVII/ XVII /CCC/		99
--------------------	--	----

[illegible]